

OWNER, DEVELOPER, CONTRACTOR SIGNED STATEMENT

ALL CLEARING, GRADING, CONSTRUCTION OR DEVELOPMENT WILL BE DONE PURSUANT TO THE PLAN, SIGNED BY PARTIES BELOW:

OWNER: _____

DEVELOPER: _____

CONTRACTOR: _____

OWNER INFORMATION

OWNER: CPM DEVELOPMENT
2919 KNOX AVE. SOUTH, SUITE 200,
MINNEAPOLIS, MN 55408

REMOVAL NOTES:

1. SEE STORM WATER POLLUTION PREVENTION PLAN (SWPPP) PLAN FOR CONSTRUCTION STORM WATER MANAGEMENT PLAN.
2. REMOVAL OF MATERIALS NOTED ON THE DRAWINGS SHALL BE IN ACCORDANCE WITH MNDOT, STATE AND LOCAL REGULATIONS.
3. REMOVAL OF PRIVATE UTILITIES SHALL BE COORDINATED WITH UTILITY OWNER PRIOR TO CONSTRUCTION ACTIVITIES.
4. EXISTING PAVEMENTS SHALL BE SAWCUT IN LOCATIONS AS SHOWN ON THE DRAWINGS OR THE NEAREST JOINT FOR PROPOSED PAVEMENT CONNECTIONS.
5. REMOVED MATERIALS SHALL BE DISPOSED OF TO A LEGAL OFF-SITE LOCATION AND IN ACCORDANCE WITH STATE AND LOCAL REGULATIONS.
6. ABANDON, REMOVE, CONNECTION, AND PROTECTION NOTES SHOWN ON THE DRAWINGS ARE APPROXIMATE. COORDINATE WITH PROPOSED PLANS.
7. EXISTING ON-SITE FEATURES NOT NOTED FOR REMOVAL SHALL BE PROTECTED THROUGHOUT THE DURATION OF THE CONTRACT.
8. PROPERTY LINES SHALL BE CONSIDERED GENERAL CONSTRUCTION LIMITS UNLESS OTHERWISE NOTED ON THE DRAWINGS. WORK WITHIN THE GENERAL CONSTRUCTION LIMITS SHALL INCLUDE STAGING, DEMOLITION AND CLEAN-UP OPERATIONS AS WELL AS CONSTRUCTION SHOWN ON THE DRAWINGS.
9. MINOR WORK OUTSIDE OF THE GENERAL CONSTRUCTION LIMITS SHALL BE ALLOWED AS SHOWN ON THE PLAN AND PER CITY REQUIREMENTS.
10. DAMAGE BEYOND THE PROPERTY LIMITS CAUSED BY CONSTRUCTION ACTIVITY SHALL BE REPAIRED IN A MANNER APPROVED BY THE ENGINEER/LANDSCAPE ARCHITECT OR IN ACCORDANCE WITH THE CITY.
11. PROPOSED WORK (BUILDING AND CIVIL) SHALL NOT DISTURB EXISTING UTILITIES UNLESS OTHERWISE SHOWN ON THE DRAWINGS AND APPROVED BY THE CITY PRIOR TO CONSTRUCTION.
12. SITE SECURITY MAY BE NECESSARY AND PROVIDED IN A MANNER TO PROHIBIT VANDALISM, AND THEFT, DURING AND AFTER NORMAL WORK HOURS, THROUGHOUT THE DURATION OF THE CONTRACT. SECURITY MATERIALS SHALL BE IN ACCORDANCE WITH THE CITY.
13. VEHICULAR ACCESS TO THE SITE SHALL BE MAINTAINED FOR DELIVERY AND INSPECTION ACCESS DURING NORMAL OPERATING HOURS. AT NO POINT THROUGHOUT THE DURATION OF THE CONTRACT SHALL CIRCULATION OF ADJACENT STREETS BE BLOCKED WITHOUT APPROVAL BY THE CITY PRIOR TO CONSTRUCTION ACTIVITIES.
14. ALL TRAFFIC CONTROLS SHALL BE PROVIDED AND ESTABLISHED PER THE REQUIREMENTS OF THE MINNESOTA MANUAL ON UNIFORM TRAFFIC CONTROL DEVICES (MMUTCD) AND THE CITY. THIS SHALL INCLUDE, BUT NOT BE LIMITED TO, SIGNAGE, BARRICADES, FLASHERS, AND FLAGGERS AS NEEDED. ALL PUBLIC STREETS SHALL REMAIN OPEN TO TRAFFIC AT ALL TIMES. NO ROAD CLOSURES SHALL BE PERMITTED WITHOUT APPROVAL BY THE CITY.
15. SHORING FOR BUILDING EXCAVATION MAY BE USED AT THE DISCRETION OF THE CONTRACTOR AND AS APPROVED BY THE OWNERS REPRESENTATIVE AND THE CITY PRIOR TO CONSTRUCTION ACTIVITIES.
16. STAGING, DEMOLITION, AND CLEAN-UP AREAS SHALL BE WITHIN THE PROPERTY LIMITS AS SHOWN ON THE DRAWINGS AND MAINTAINED IN A MANNER AS REQUIRED BY THE CITY.

CITY OF MINNEAPOLIS REMOVAL NOTES:

1. RESERVED FOR CITY SPECIFIC REMOVAL NOTES.

EROSION CONTROL NOTES:

SEE SWPPP ON SHEETS SW1.0-SW1.3

REMOVALS LEGEND:

- 932 ----- EX. 1' CONTOUR ELEVATION INTERVAL
- [Hatched Pattern] REMOVAL OF PAVEMENT AND ALL BASE MATERIAL, INCLUDING BIT., CONC., AND GRAVEL PVMTS.
- [Cross-hatched Pattern] REMOVAL OF STRUCTURE INCLUDING ALL FOOTINGS AND FOUNDATIONS.
- [Dashed Circle] TREE PROTECTION
- [X] TREE REMOVAL - INCLUDING ROOTS AND STUMPS

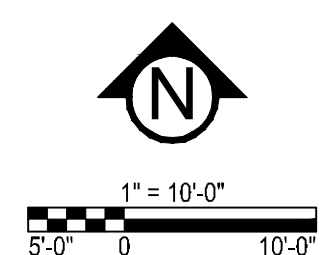
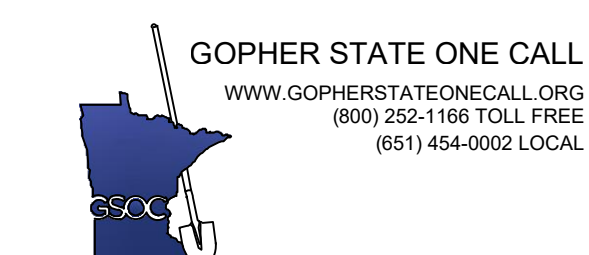

CivilSite
GROUP
4931 W. 35TH ST. SUITE 200
ST. LOUIS PARK, MN 55416
CivilSiteGroup.com
Matt Pavek 763-213-3944 Pat Sarver 952-250-2003

DJR
ARCHITECTURE, INC.
333 Washington Ave N, Suite 210
Minneapolis, Minnesota 55401
612.676.2700 www.djr-inc.com

PROJECT
1501 COMO AVE. RESIDENTIAL DEVELOPMENT
1501 COMO AVE SOUTHEAST, MINNEAPOLIS, MN
CPM DEVELOPMENT
2919 KNOX AVE. SOUTH, SUITE 200, MINNEAPOLIS, MN 55408

I HEREBY CERTIFY THAT THIS PLAN, SPECIFICATION, OR REPORT WAS PREPARED BY ME OR UNDER MY DIRECT SUPERVISION AND THAT I AM A DULY LICENSED PROFESSIONAL ENGINEER UNDER THE LAWS OF THE STATE OF MINNESOTA.

Matthew R. Pavek
Matthew R. Pavek
DATE 07/15/16 LICENSE NO. 44263

ISSUE/SUBMITTAL SUMMARY

DATE	DESCRIPTION
7/15/16	PDR SUBMITTAL

REVISION SUMMARY

DATE	DESCRIPTION

PROJECT NO. 15128

REMOVALS PLAN

C1.0

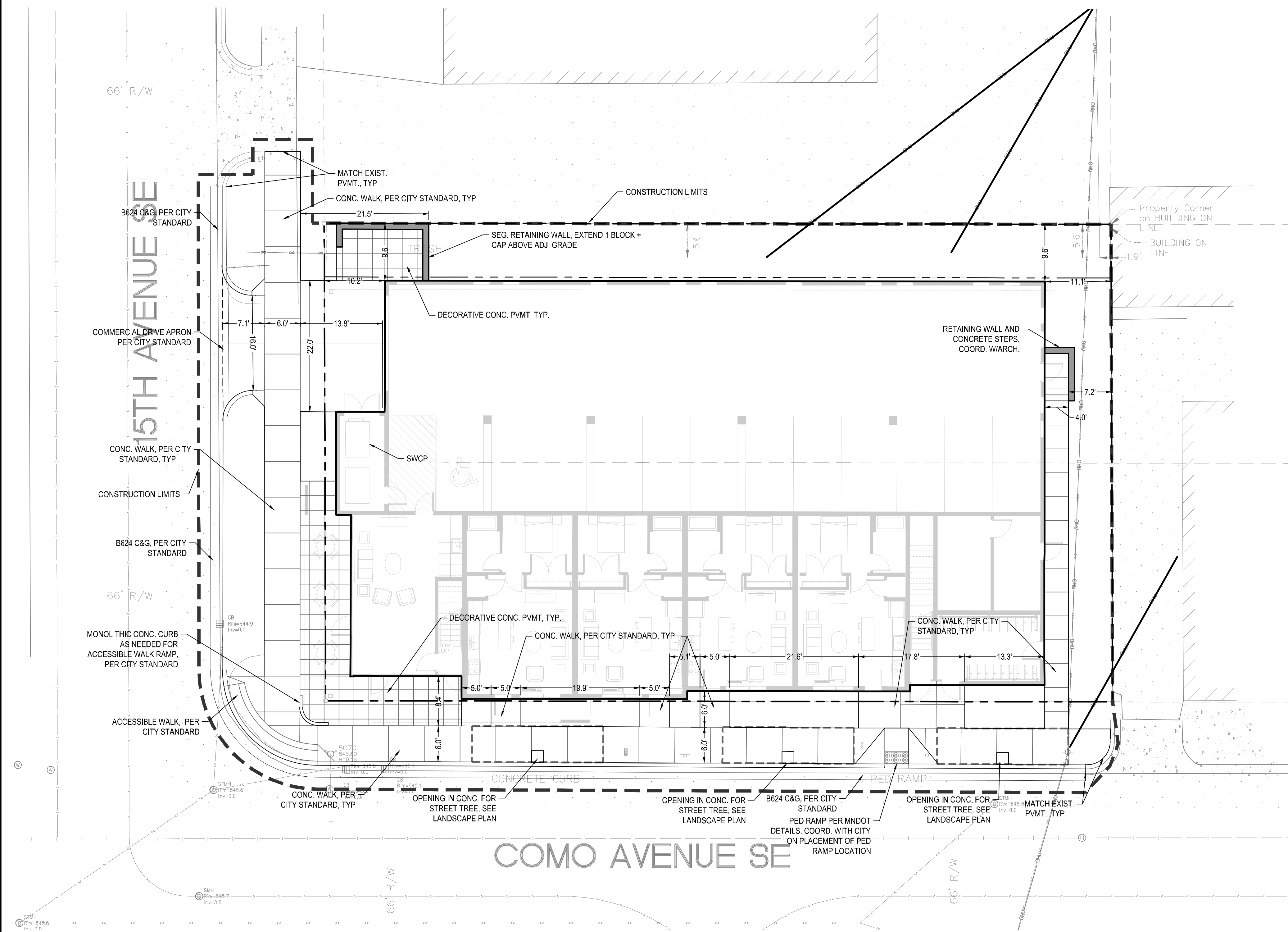

SITE AREA CALCULATIONS:

SITE AREA CALCULATIONS	EXISTING		PROPOSED	
	SF	%	SF	%
BUILDING COVERAGE	3,244 SF	30.7%	7,896 SF	74.7%
ALL PAVEMENTS	7,182 SF	68.0%	899 SF	8.5%
ALL NON-PAVEMENTS	139 SF	1.3%	1,770 SF	16.7%
TOTAL SITE AREA	10,565 SF	100.0%	10,565 SF	100.0%
IMPERVIOUS SURFACE				
EXISTING CONDITION	10,426 SF	98.7%		
PROPOSED CONDITION	8,795 SF	83.3%		
DIFFERENCE (EX. VS PROP.)	-1,631 SF	-15.4%		
IMPERVIOUS TOTAL	8,795 SF	83.3%		

SITE LAYOUT NOTES:

- CONTRACTOR SHALL VERIFY LOCATIONS AND LAYOUT OF ALL SITE ELEMENTS PRIOR TO BEGINNING CONSTRUCTION, INCLUDING BUT NOT LIMITED TO, LOCATIONS OF EXISTING AND PROPOSED PROPERTY LINES, EASEMENTS, SETBACKS, UTILITIES, BUILDINGS AND PAVEMENTS. CONTRACTOR IS RESPONSIBLE FOR FINAL LOCATIONS OF ALL ELEMENTS FOR THE SITE. ANY REVISIONS REQUIRED AFTER COMMENCEMENT OF CONSTRUCTION, DUE TO LOCAL ADJUSTMENTS SHALL BE CORRECTED AT NO ADDITIONAL COST TO OWNER. ADJUSTMENTS TO THE LAYOUT SHALL BE APPROVED BY THE ENGINEER/LANDSCAPE ARCHITECT PRIOR TO INSTALLATION OF MATERIALS. STAKE LAYOUT FOR APPROVAL.
- THE CONTRACTOR SHALL OBTAIN ALL NECESSARY PERMITS PRIOR TO CONSTRUCTION, INCLUDING A RIGHT-OF-WAY AND STREET OPENING PERMIT.
- THE CONTRACTOR SHALL VERIFY RECOMMENDATIONS NOTED IN THE GEO TECHNICAL REPORT PRIOR TO INSTALLATION OF SITE IMPROVEMENT MATERIALS.
- CONTRACTOR SHALL FIELD VERIFY COORDINATES AND LOCATION DIMENSIONS OF THE BUILDING AND STAKE FOR REVIEW AND APPROVAL BY THE OWNERS REPRESENTATIVE PRIOR TO INSTALLATION OF FOOTING MATERIALS.
- LOCATIONS OF STRUCTURES, ROADWAY PAVEMENTS, CURBS AND GUTTERS, BOLLARDS, AND WALKS ARE APPROXIMATE AND SHALL BE STAKED IN THE FIELD, PRIOR TO INSTALLATION, FOR REVIEW AND APPROVAL BY THE ENGINEER/LANDSCAPE ARCHITECT.
- CURB DIMENSIONS SHOWN ARE TO FACE OF CURB. BUILDING DIMENSIONS ARE TO FACE OF CONCRETE FOUNDATION. LOCATION OF BUILDING IS TO BUILDING FOUNDATION AND SHALL BE AS SHOWN ON THE DRAWINGS.
- THE CONTRACTOR SHALL SUBMIT SHOP DRAWINGS OR SAMPLES AS SPECIFIED FOR REVIEW AND APPROVAL BY THE ENGINEER/LANDSCAPE ARCHITECT PRIOR TO FABRICATION FOR ALL PREFABRICATED SITE IMPROVEMENT MATERIALS SUCH AS, BUT NOT LIMITED TO THE FOLLOWING, FURNISHINGS, PAVEMENTS,

- WALLS, RAILINGS, BENCHES, FLAGPOLES, LANDING PADS FOR CURB RAMPS, AND LIGHT AND POLES. THE OWNER RESERVES THE RIGHT TO REJECT INSTALLED MATERIALS NOT PREVIOUSLY APPROVED.
- PEDESTRIAN CURB RAMPS SHALL BE CONSTRUCTED WITH TRUNCATED DOME LANDING AREAS IN ACCORDANCE WITH A.D.A. REQUIREMENTS-SEE DETAIL.
- CROSSWALK STRIPING SHALL BE 24" WIDE WHITE PAINTED LINE, SPACED 48" ON CENTER PERPENDICULAR TO THE FLOW OF TRAFFIC. WIDTH OF CROSSWALK SHALL BE 5' WIDE. ALL OTHER PAVEMENT MARKINGS SHALL BE WHITE IN COLOR UNLESS OTHERWISE NOTED OR REQUIRED BY ADA OR LOCAL GOVERNING BODIES.
- CURB AND GUTTER TYPE SHALL BE B612 UNLESS OTHERWISE NOTED ON THE DRAWINGS-TAPER BETWEEN CURB TYPES-SEE DETAIL.
- ALL CURB RADII ARE MINIMUM 3' UNLESS OTHERWISE NOTED.
- CONTRACTOR SHALL REFER TO FINAL PLAT FOR LOT BOUNDARIES, NUMBERS, AREAS AND DIMENSIONS PRIOR TO SITE IMPROVEMENTS.
- FIELD VERIFY ALL EXISTING SITE CONDITIONS, DIMENSIONS.
- PARKING IS TO BE SET PARALLEL OR PERPENDICULAR TO EXISTING BUILDING UNLESS NOTED OTHERWISE.
- ALL PARKING LOT PAINT STRIPPING TO BE WHITE, 4" WIDE TYP.
- BITUMINOUS PAVING TO BE "LIGHT DUTY" UNLESS OTHERWISE NOTED. SEE DETAIL SHEETS FOR PAVEMENT SECTIONS.
- ALL TREES THAT ARE TO REMAIN ARE TO BE PROTECTED FROM DAMAGE WITH A CONSTRUCTION FENCE AT THE DRIP LINE. SEE LANDSCAPE DOCUMENTS.

OWNER INFORMATION

OWNER: CPM DEVELOPMENT
2919 KNOX AVE. SOUTH, SUITE 200,
MINNEAPOLIS, MN 55408

OPERATIONAL NOTES:

- ALL SNOW WILL EITHER BE PLOWED TO THE LANDSCAPED AREAS OR WILL BE REMOVED FROM SITE AT EACH PLOWING
- TRASH REMOVAL AND REGULAR DELIVERIES SHALL OCCUR AT THE GARAGE ENTRANCE DRIVE.

CITY COORDINATION NOTES:

- TRAFFIC & PARKING
 - COORDINATE WITH BILL PRINCE, CITY OF MINNEAPOLIS, (612) 673-3901 FOR ALL WORK REGARDING STREET LIGHTING AND ELECTRICAL SYSTEMS. STREET LIGHTING INSTALLED AS PART OF THE PROJECT SHALL BE INSPECTED BY THE CITY, CONTACT DAVE PREHALL (612) 673-5759. ANY LIGHTING INSTALLATIONS NOT MEETING CITY SPECIFICATIONS WILL BE REQUIRED TO BE REINSTALLED AT CONTRACTOR'S EXPENSE.
 - COORDINATE WITH BOB BOBLETT CITY OF MINNEAPOLIS, (612) 673-2428 FOR ALL ISSUES REGARDING CURB AND ADJACENT TO CITY RIGHTS-OF-WAY. AN ENCROACHMENT PERMIT SHALL BE REQUIRED FOR ALL STREETScape ELEMENTS IN THE PUBLIC ROW. ANY ELEMENTS OF AN EARTH RETENTION SYSTEM AND RELATED OPERATIONS WILL REQUIRE AN ENCROACHMENT PERMIT. ANY EXCAVATIONS THAT FALL WITHIN THE PUBLIC ROW WILL REQUIRE A ROW EXCAVATION PERMIT.
 - COORDINATE WITH SCOTT KRAMER, CITY OF MINNEAPOLIS, (612) 673-2383 REGARDING ANY WORK THAT IS PERFORMED IN THE RIGHT-OF-WAY. AN OBSTRUCTION PERMIT WILL BE REQUIRED FOR ALL WORK IN THE RIGHT-OF-WAY. CONTACT SCOTT KRAMER REGARDING DETAILS OF SIDEWALK AND LANE CLOSURES.
 - COORDINATE WITH CRAIG PINKALLA, CITY OF MINNEAPOLIS, (612) 499-9233 FOR ALL WORK REGARDING REMOVAL OR PROTECTION OF TREES DURING CONSTRUCTION IN THE CITY RIGHT-OF-WAY.
 - COORDINATE WITH PAUL CAO, CITY OF MINNEAPOLIS, (612) 673-2943 FOR ALL WORK REGARDING BIKE RACKS IN THE CITY RIGHT-OF-WAY.
 - COORDINATE WITH ALLAN KLUGMAN, CITY OF MINNEAPOLIS, (612) 673-5750 PRIOR TO CONSTRUCTION FOR THE TEMPORARY REMOVAL/RELOCATION OF ANY CITY OF MINNEAPOLIS SIGNAL SYSTEM. ALL COSTS FOR RELOCATION AND/OR REPAIR OF CITY TRAFFIC SHALL BE BORNE BY THE CONTRACTOR.
 - COORDINATE WITH DOUG MADAY, CITY OF MINNEAPOLIS, (612) 673-5755 PRIOR TO CONSTRUCTION FOR THE REMOVAL OR RELOCATION OF ANY CITY OF MINNEAPOLIS RIGHT-OF-WAY SIGNS.
- ENVIRONMENTAL HEALTH
 - COORDINATE WITH ENVIRONMENTAL SERVICES, CITY OF MINNEAPOLIS, (612) 673-3867 FOR PERMITS RELATING TO AFTER HOURS WORK, TEMPORARY STORAGE OF IMPACTED SOILS ON SITE PRIOR TO DISPOSAL OR REUSE, REMEDIATION OF CONTAMINATED SOIL AND GROUNDWATER, REUSE OF IMPACTED SOILS ON SITE, DEWATERING AND DISCHARGE OF ACCUMULATED STORM WATER OR GROUND WATER TO CITY SEWERS, FLAMMABLE WASTE TRAPS, UNDERGROUND OR ABOVEGROUND TANK INSTALLATION OR REMOVAL, WELL CONSTRUCTION OR SEALING, OR ON-SITE ROCK CRUSHING.
 - NO CONSTRUCTION, DEMOLITION OR COMMERCIAL POWER MAINTENANCE EQUIPMENT SHALL BE OPERATED WITHIN THE CITY BETWEEN THE HOURS OF 6:00 PM AND 7:00 AM ON WEEKDAYS OR DURING ANY HOURS ON SATURDAYS, SUNDAYS AND STATE AND FEDERAL HOLIDAYS, EXCEPT UNDER PERMIT.
 - IF CONTAMINATED SOIL IS ENCOUNTERED, IT MUST BE REPORTED TO THE MINNESOTA DUTY OFFICER AT (651) 649-5451. PREAPPROVAL FOR REMOVAL OR REUSE MUST OCCUR FROM THE MPCA AND THE CITY OF MINNEAPOLIS.
- FORESTRY DEPARTMENT
 - TO PROTECT ROOT ZONES, NO CONSTRUCTION EQUIPMENT OR MATERIALS SHALL BE PLACED, PARKED, OR STORED ON ANY UNPAVED AREA WITHIN THE DRIP LINE OF ANY CITY OWNED TREE. NO CHEMICALS OR PETROLEUM PRODUCTS SHALL BE DEPOSITED ON ANY UNPAVED AREA IN THE CITY RIGHT-OF-WAY.
 - ANY TREE ROOTS ENCOUNTERED ARE TO BE CLEANLY CUT USING HAND TOOLS.
 - NO OPEN EXCAVATION OR BORE PITS ALLOWED WITHIN 8 FEET OF CITY STREET TREES.
 - CARE SHALL BE TAKEN NOT TO DAMAGE TREE TRUNKS OR BRANCHES. CONTRACTOR MUST CONTACT FORESTRY DEPARTMENT INSPECTIONS (CRAIG PINKALLA) AT (612) 499-9233 AT LEAST 3 DAYS PRIOR TO STARTING WORK TO DISCUSS PROBLEMS OF OVERHANGING BRANCHES THAT MAY BE DAMAGED.

CITY OF MINNEAPOLIS SITE SPECIFIC NOTES:

- RESERVED FOR CITY SPECIFIC NOTES.

SITE PLAN LEGEND:

- CONCRETE PAVEMENT AS SPECIFIED (PAD OR WALK)
- PROPERTY LINE
- CURB AND GUTTER-SEE NOTES (T.O.) TIP OUT GUTTER WHERE APPLICABLE-SEE PLAN
- TRAFFIC DIRECTIONAL ARROWS
- SIGN AND POST ASSEMBLY. SHOP DRAWINGS REQUIRED.
HC = ACCESSIBLE SIGN
NP = NO PARKING FIRE LANE
ST = STOP
CP = COMPACT CAR PARKING ONLY

CivilSite
G R O U P
4931 W. 35TH ST. SUITE 200
ST. LOUIS PARK, MN 55416
CivilSiteGroup.com
Matt Pavak 763-213-3944 Pat Sarver 952-250-2003

DJR
ARCHITECTURE, INC.
333 Washington Ave N, Suite 210
Minneapolis, Minnesota 55401
612.676.2700 www.djr-inc.com

PROJECT

1501 COMO AVE. RESIDENTIAL DEVELOPMENT

1501 COMO AVE SOUTHEAST, MINNEAPOLIS, MN

CPM DEVELOPMENT

2919 KNOX AVE. SOUTH, SUITE 200, MINNEAPOLIS, MN 55408

I HEREBY CERTIFY THAT THIS PLAN, SPECIFICATION, OR REPORT WAS PREPARED BY ME OR UNDER MY DIRECT SUPERVISION AND THAT I AM A DULY LICENSED PROFESSIONAL ENGINEER UNDER THE LAWS OF THE STATE OF MINNESOTA.

Matthew R. Pavak
DATE 07/13/16 LICENSE NO. 44263

ISSUE/SUBMITTAL SUMMARY

DATE	DESCRIPTION
7/15/16	PDR SUBMITTAL

REVISION SUMMARY

DATE	DESCRIPTION

PROJECT NO. 15128

SITE PLAN

C2.0

GOPHER STATE ONE CALL
WWW.GOPHERSTATEONECALL.ORG
(800) 252-1166 TOLL FREE
(651) 454-0002 LOCAL

1" = 10'-0"
5'-0" 0 10'-0"