

NOTES TO THE GRADING CONTRACTOR

- IT SHALL BE THE CONTRACTOR'S RESPONSIBILITY TO LOCATE ALL STRUCTURES, UNDERGROUND PIPELINES, ELECTRICAL AND TELEPHONE CONDUITS, EITHER SHOW OR NOT SHOWN ON THE PLANS PRIOR TO CONSTRUCTION, AND TO OBSERVE ALL POSSIBLE PRECAUTIONS TO AVOID ANY DAMAGE TO THESE FACILITIES. THE ENGINEER AND/OR DEVELOPER WILL NOT GUARANTEE ANY ELEVATIONS OR LOCATIONS OF EXISTING UNDERGROUND UTILITIES SHOWN ON THESE PLANS.
- IT SHALL BE THE RESPONSIBILITY OF THE BIDDER TO VERIFY ALL QUANTITIES, INCLUDING EXCAVATION, BORROW, EMBANKMENT, SHRINK OR SWELL, GROUND COMPACTION, HAUL, AND ANY OTHER ITEMS AFFECTING THE BID TO COMPLETE THE GRADING TO THE ELEVATIONS SHOWN ON THESE PLANS AND TO BASE THE BID SOLELY UPON HIS OWN VERIFIED QUANTITIES. IT SHALL BE THE BIDDERS RESPONSIBILITY TO NOTIFY THE ENGINEER PRIOR TO CONSTRUCTION OF ANY MAJOR DISCREPANCIES BETWEEN HIS ESTIMATE QUANTITIES AND THOSE SHOWN ON THESE PLANS.
- IF STRIPPING OR SOME TOPSOIL IS DEEMED UNSUITABLE BY THE SOILS ENGINEER FOR USE AS COMPACTED FILL, THE UNSUITABLE MATERIAL SHALL BE STOCKPILED PRIOR TO ROUGH GRADING AND USED TO FINISH SUITABLE AREAS AT COMPLETION OF ROUGH GRADING.
- ANY EARTHWORK QUANTITIES SHOWN ON THESE PLANS WERE BASED ON THE ASSUMPTION THAT THE ENTIRE SITE WILL BE GRADED IN ONE OPERATION.
- ALL FILL SHALL BE PLACED, COMPACTED, AND FILL SITES PREPARED IN ACCORDANCE WITH THE RECOMMENDATIONS OF THE SOIL INVESTIGATION REPORT.
- DUST SHALL BE CONTROLLED BY WATERING PER THE STANDARDS OF LOCAL GOVERNING AGENCY. THE CONTRACTOR SHALL OBTAIN ALL NECESSARY PERMITS.
- ALL WORK AND MATERIALS WHICH DO NOT CONFORM TO THESE PLANS ARE SUBJECT TO REMOVAL AND REPLACEMENT AT THE CONTRACTOR'S EXPENSE.
- THE ENGINEER IS NOT RESPONSIBLE FOR CONSTRUCTION STAKING. THE CONTRACTOR WILL BE RESPONSIBLE FOR CONSTRUCTION STAKING.
- ALL TEMPORARY WATER AND POWER FACILITIES SHALL BE REMOVED PRIOR TO FINAL ACCEPTANCE BY THE DEVELOPER.
- ANY QUESTION RAISED RELATIVE TO THE ACCURACY OF IMPROVEMENT INSTALLATION SHALL BE RAISED PRIOR TO THE COMMENCEMENT OF THE WORK IN QUESTION.
- GRADES REFLECTED IN THE RETENTION BASINS ARE FINISHED GRADES. IF THE CONTRACTOR PLANS TO PLACE SPOIL DIRT FROM FOOTINGS, UTILITY TRENCHES, ETC., IN THE BASINS, THE BASINS SHOULD BE APPROPRIATELY UNDER CUT DURING THE ROUGH GRADING OPERATION TO RESULT IN THE DESIGN GRADES.
- THE CONTRACTOR SHALL PROVIDE A 1 FOOT MINIMUM BENCH BETWEEN THE TOP OF ALL LANDSCAPE SLOPES AND THE BACK OF CURBS AND SIDEWALKS.
- THE CONTRACTOR SHALL FURNISH ALL MATERIALS, LABOR AND EQUIPMENT TO CONSTRUCT/INSTALL THE IMPROVEMENTS SHOWN ON THESE PLANS UNLESS SPECIFICALLY NOTED OTHERWISE.
- DIMENSIONS SHOWN ON THESE PLANS ARE FOR REFERENCE ONLY. SEE THE ARCHITECT'S DIMENSIONED SITE PLAN OR HORIZONTAL CONTROL PLAN FOR SITE LAYOUT. DO NOT SCALE THESE PLANS.
- THE CONTRACTOR SHALL PROVIDE PARKING STRIPES BASED ON THE ARCHITECT'S SITE PLAN. THE STRIPING SHOWN ON THE CIVIL PLANS IS FOR REFERENCE ONLY.
- THE INVERT ELEVATIONS SHOWN ON THESE PLANS HAVE BEEN DESIGNED TO PROVIDE AT LEAST ONE (1) FOOT OF COVER OVER THE TOP OF THE PIPE (EXCLUDING THE PAVEMENT THICKNESS). THE CONTRACTOR IS RESPONSIBLE FOR PROTECTING THE NEWLY INSTALLED PIPES FROM DAMAGE CAUSED BY CONSTRUCTION ACTIVITY ON THE SITE PRIOR TO THE FINAL PAVEMENT SECTION BEING INSTALLED.

17. CONTRACTOR TO VERIFY ELEVATION OF EXISTING FACILITIES MATCH LOCATIONS. ENGINEER IS TO BE NOTIFIED PRIOR TO CONSTRUCTION OF ANY DISCREPANCIES.

18. CONSTRUCTION SITE SAFETY IS THE SOLE RESPONSIBILITY OF THE CONTRACTOR. NEITHER THE ENGINEER OR OWNER ASSUMES ANY RESPONSIBILITY FOR SAFETY OF THE CONSTRUCTION ACTIVITY, PERSONS ENGAGED IN THE WORK, OR OTHER PERSONS IN RESIDENCE IN THE AREA.

- LEGEND**
- CENTERLINE**
- XX EXISTING LINE
 - XX OR XX EXISTING MANHOLES, VAULTS AND BOXES
 - ☀ LIGHT
 - CLEANOUT
 - ⊕ FDC FIRE DEPT. CONNECTION
 - ▭ EXISTING CONCRETE
 - 🌳 TREE
 - 🌴 PALM TREE
 - FOUND BRASS CAP

- ABBREVIATIONS**
- C CONCRETE
 - EM ELECTRIC METER
 - E ELECTRIC
 - G GAS
 - GD GROUND
 - GS GRASS
 - P PAVEMENT
 - RD ROOF DRAIN
 - SCO SEWER CLEANOUT
 - SS SANITARY SEWER
 - T TELEPHONE
 - TC TOP OF CURB
 - W WATER

PRIME BENCHMARK

3" BRASS CAP IN HANDHOLE AT THE INTERSECTION OF HAYDEN RD & JACKRABBIT RD.

ELEVATION = 1260.159 (NAD 88 DATUM, GDAO POINT 24557-3, PER GDAO SURVEY RECORDED IN BOOK 734 PAGE 10)

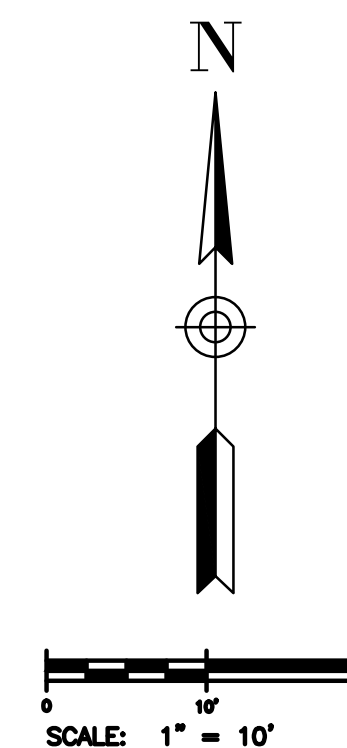
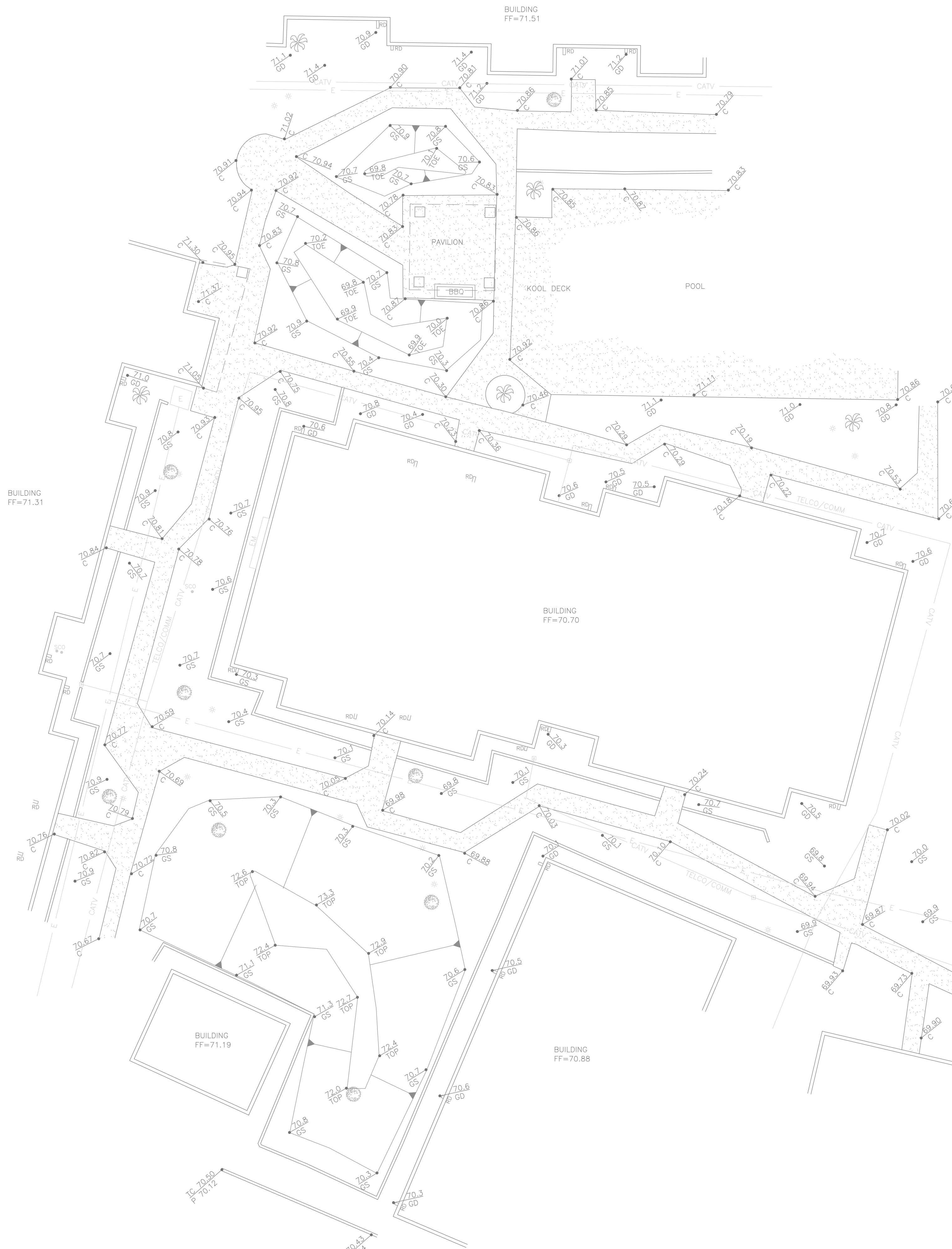

FRANK CIVIL CONSULTING

480.654.4533
P.O. BOX 22128
MESA, AZ 85277

BELLA VITA DRAINAGE REMEDIATION
5905 N. 78TH STREET
SCOTTSDALE, AZ



REVISIONS:

NO.	DATE	DESCRIPTION



DATE ISSUED: 3-20-19
DESIGNED BY: JDL
DRAWN BY: MZS
CHECKED BY: JDL
PROJECT NO. 1383
SCALE: 1" = 10'

SHEET NO.

1 OF 2