

Conduit offsets

Wednesday, August 01, 2012
8:27 PM

In Revit 2012 - As you draw you should be seeing auto-dimensional information being displayed. Similar to the compass. It will tell you the length and the angle. If this is not showing, you may have to look to see if you have it turned off. It should look like this.

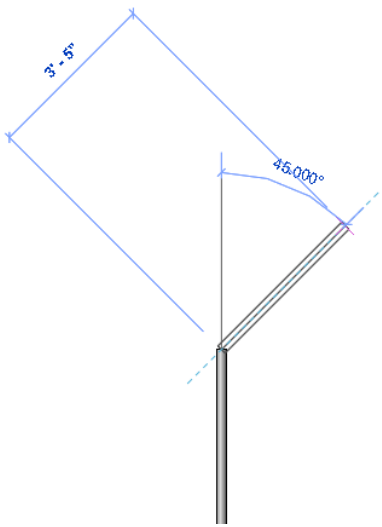

In this next example you often run into a condition where a conduit is drawn in one plane and you are trying to connect it to another conduit drawn on a different axis plane. If you just try cutting a section so you can see both of them and then select one and try to draw a conduit from the end of one to the end of the other, you'll likely get the "no auto-route solution found" error message. That's because Revit seems to like to connect items on the same plane.

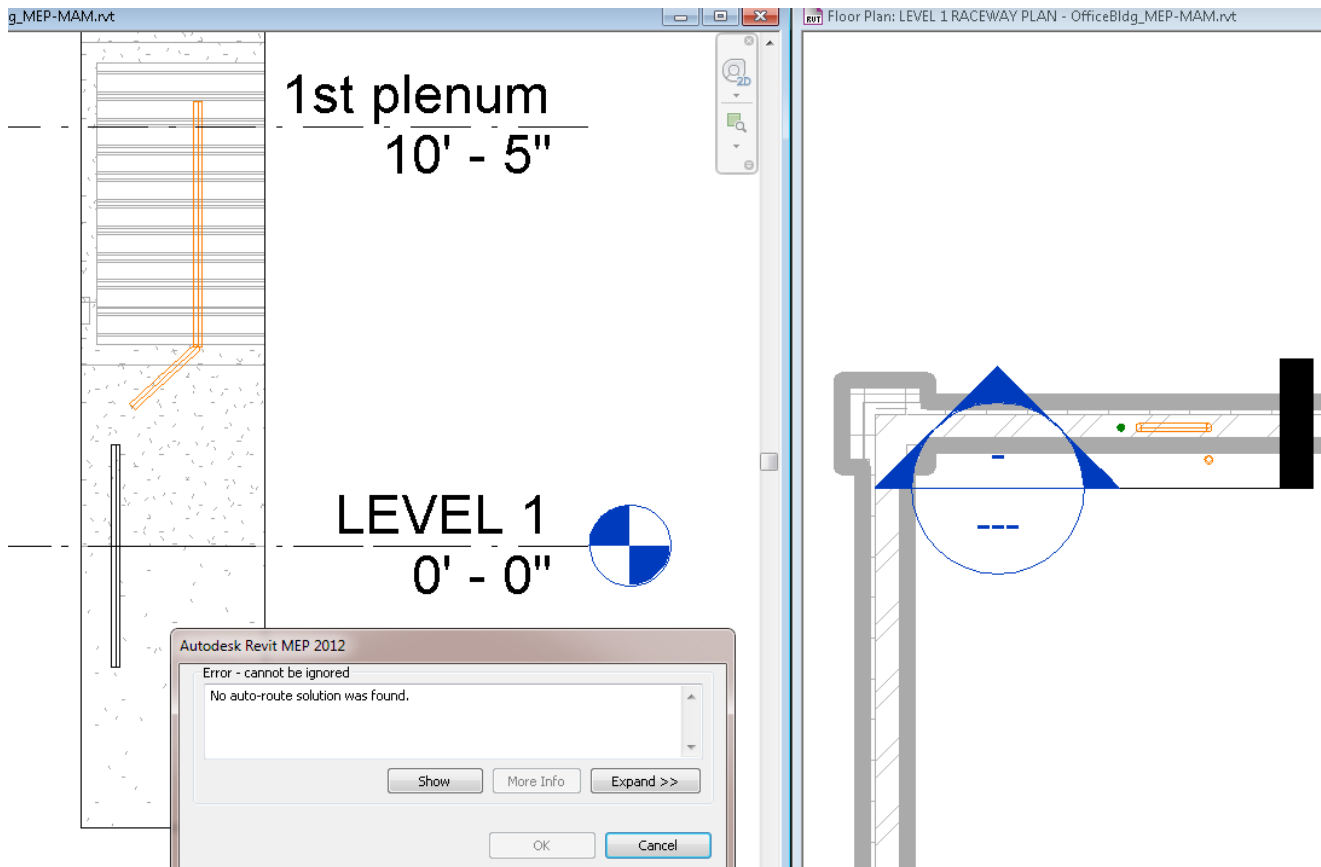

The solution to get around that is to cut a section lining up the section line right on the center of the two conduit centers. This will create a section plane that will be at an odd angle to the building, but makes the two conduits in the same plane. You can now just draw a conduit between the two conduit ends. If you want a specific angle, simply draw a conduit from either end by selecting the conduit end, click on the blue grip, right click to get the draw conduit menu item and then draw a segment a short distance at the angle you want. Stop drawing conduit

and use the fillet tool to connect the angled piece with the other piece.

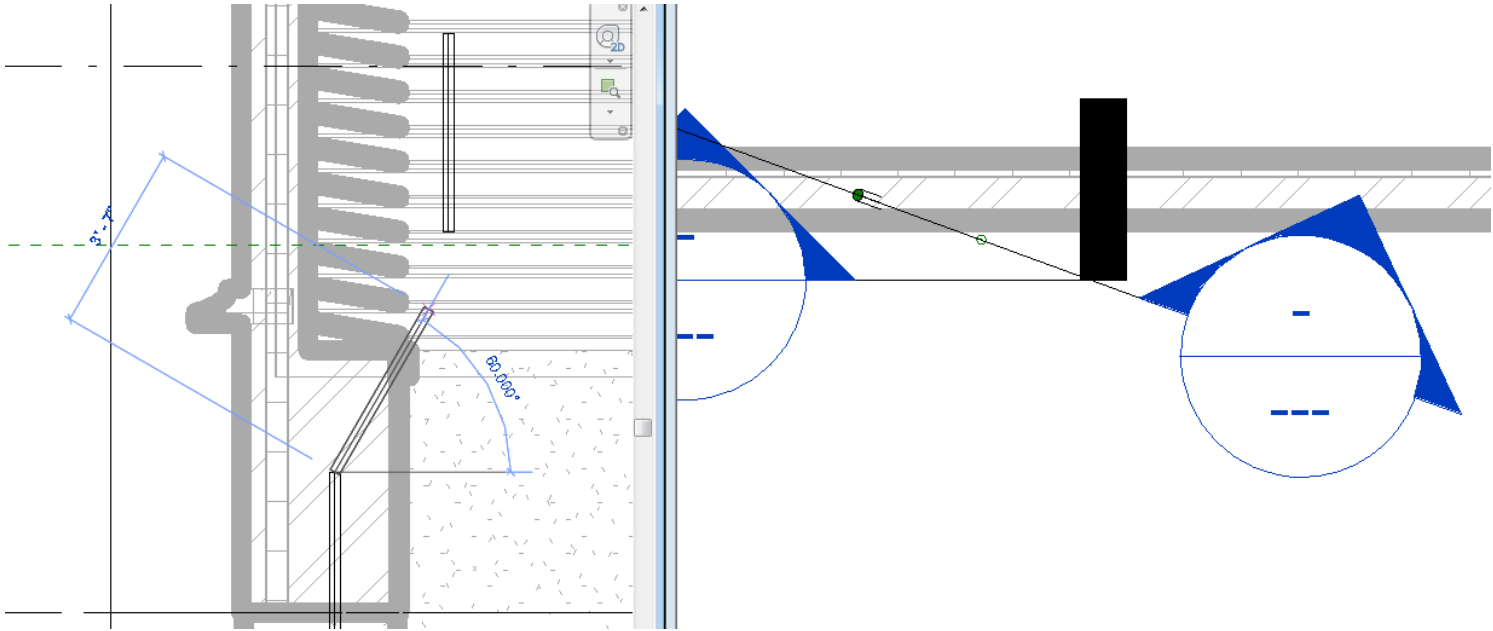

The fillet tool makes drawing complicated angles simpler.

Here's another example: Let's say you want a conduit 90-degree elbow with a kick instead of an offset or stacked elbows. In this example the conduit running north-south is at -3'-0" and the conduit running east-west is at elevation 0'-0". The left view is the section, the right view is the plan view.

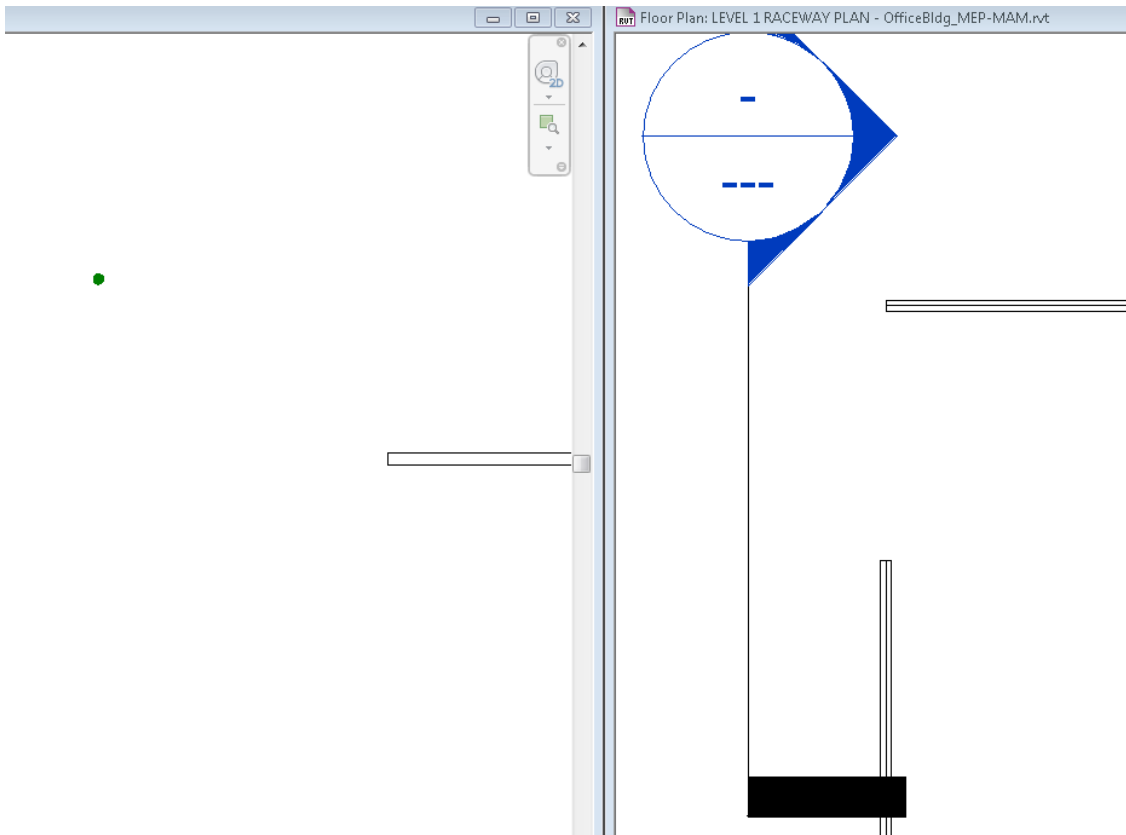

If I simple try to draw a conduit between the two ends I'll get something funky like stacked 90-degree elbows. You'll get the same thing using the fillet command.

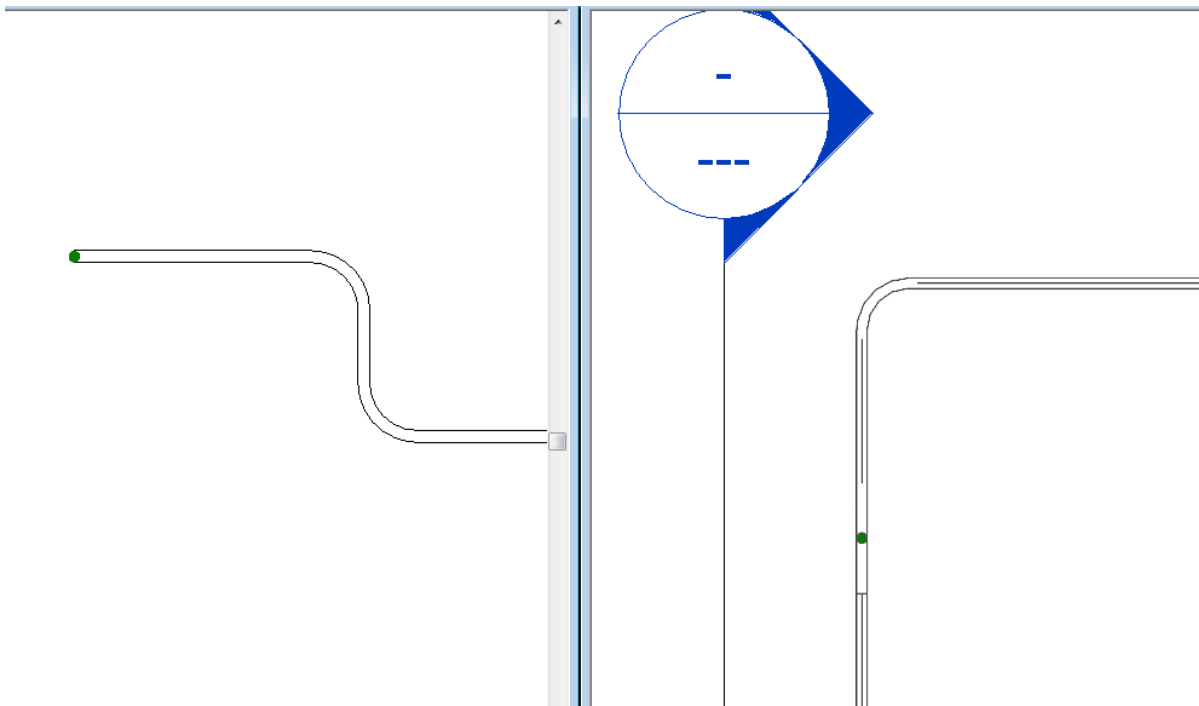

To get the elbow with a kick. Just go to the section view and draw a reference plane from the conduit to represent the angle you want.

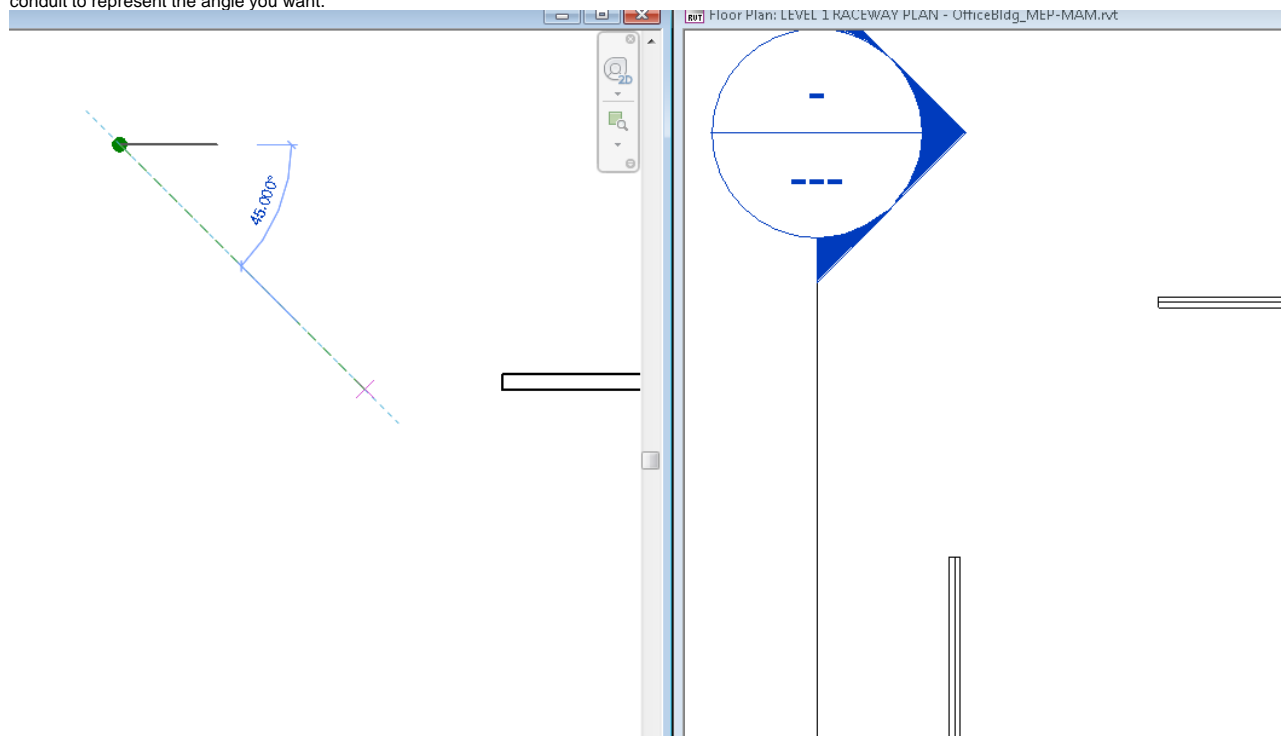

Grab the horizontal conduit and start drawing conduit over to the angled reference plane you just added and then draw it up a short distance along the reference plane. Stop drawing in section view and go back to the plan view. The just use the fillet tool to interconnect them.

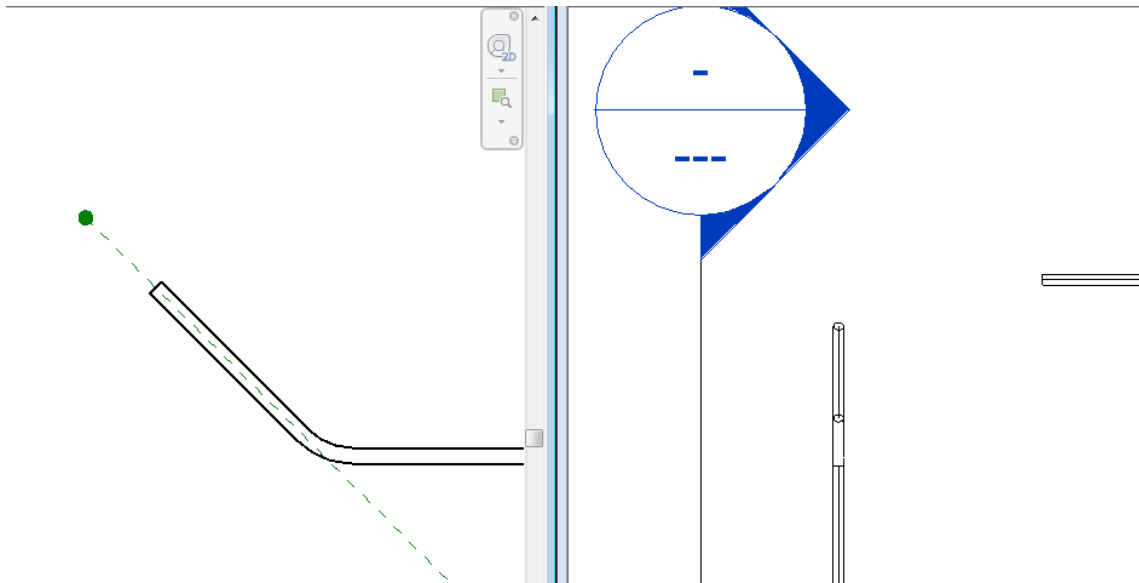

After you fillet them you'll get you conduit elbow with a kick. After you do this a few times it gets really quick.

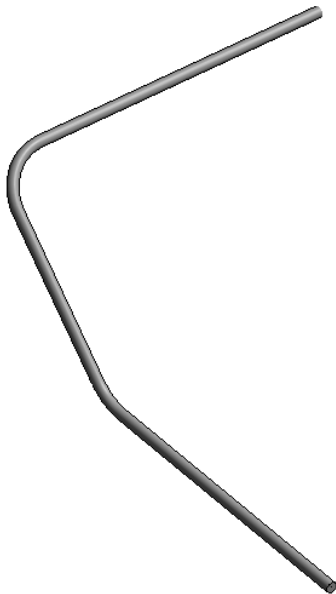

Reference planes can help draw conduit along the path you want.

Have fun!

