

TEST_2022_Aria 400f.rvt - Sheet: 7060 - MATERIAL

Railing Schedule							
Type	Count	Length	AAA	BBB	CCC	DDD	EEE
RAIL_No Stringer 5A	1	11.09					
STRINGER_No Rail 5A	1	11.09					
RAIL_No Stringer 5B	1	10.97					
STRINGER_No Rail 5B	1	10.97					

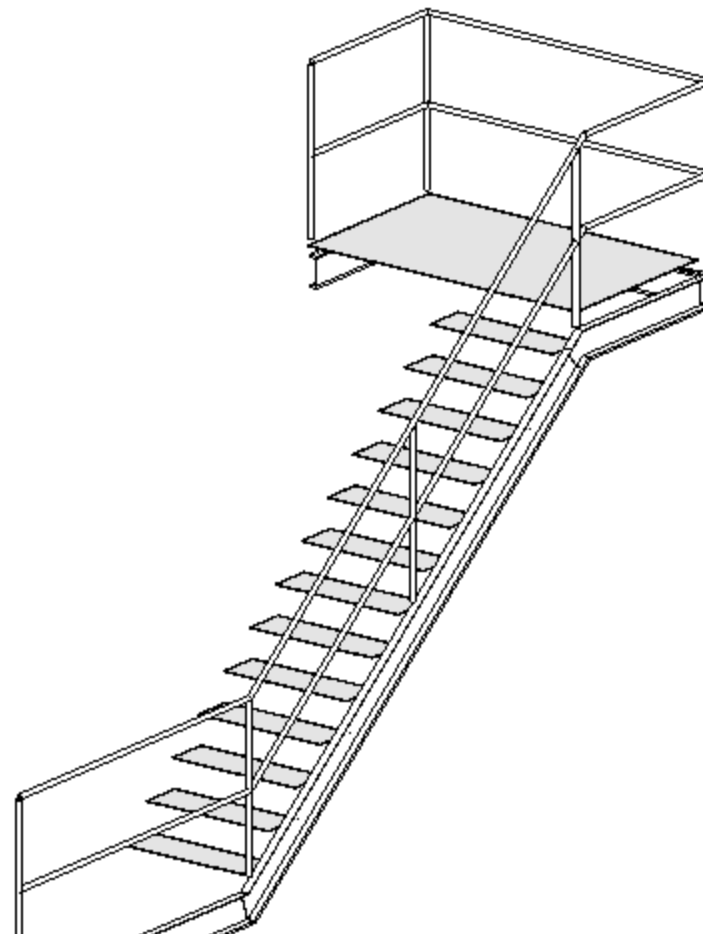

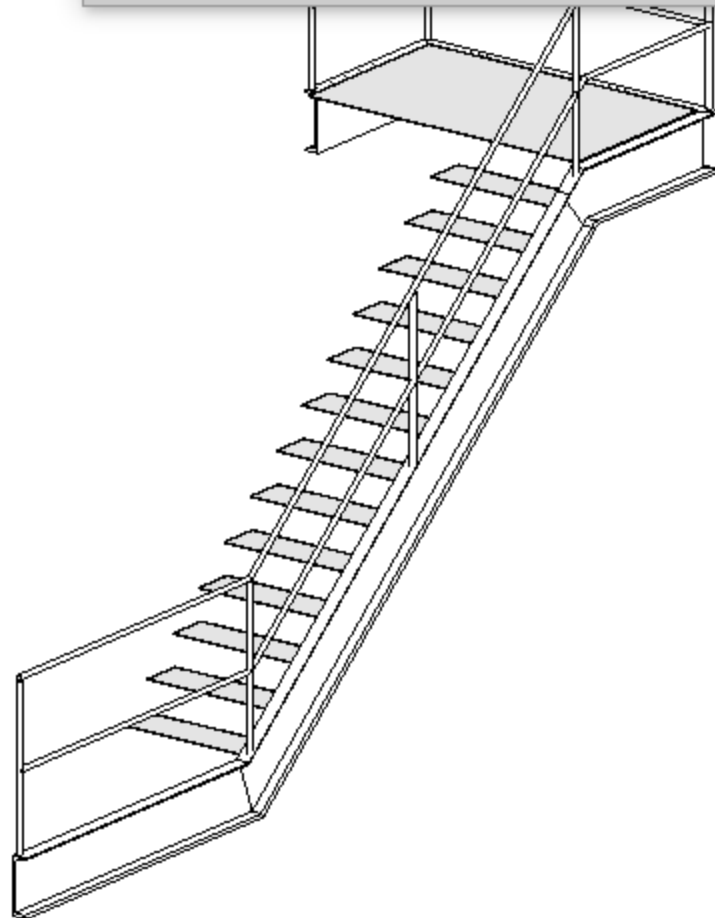
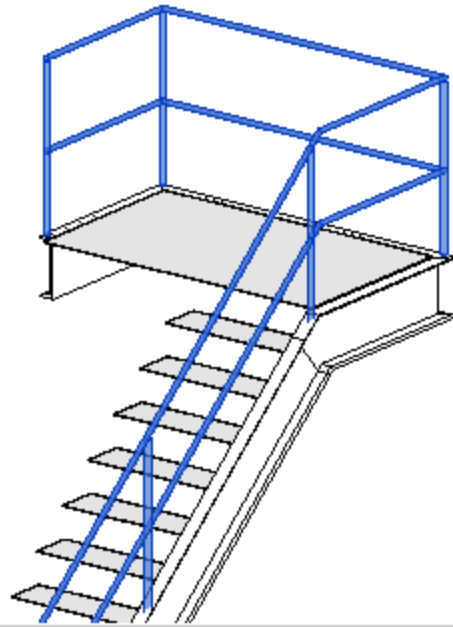

	Name	Height	Offset	Profile	Material
1	Rail 1	3' 8"	-0' 2"	My_Pipe-Profile : Pipe1STD	Metal - Steel - 345 MPa
2	Rail 2	1' 9"	-0' 2"	M_C Shapes-Profile : C200X17.1 M_Circular Handrail : 40mm M_Circular Handrail2 : 38mm M_Circular Handrail3 : 30mm My_Pipe-Profile : Pipe1STD My_Pipe-Profile : Pipe1XS	Metal - Steel - 345 MPa

InsertDuplicateDelete

UpDown

1920 × 1080px

Size: 207.7KB

100%

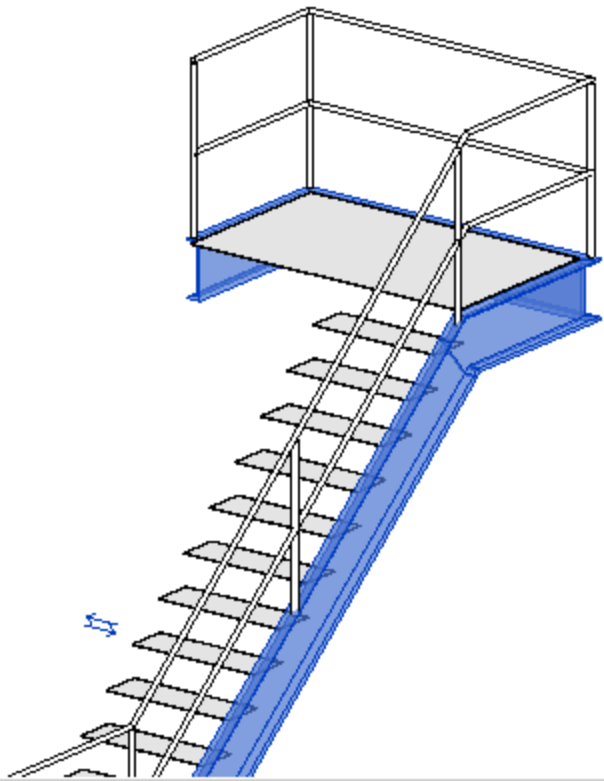

	Name	Height	Offset	Profile	Material
1	STRINGER-5A	-0' 8"	-0' 1"	C-Channel-Profile : C15X50	Metal - Steel - 345 MPa

InsertDuplicateDelete

UpDown

OK

Cancel

Apply

Help

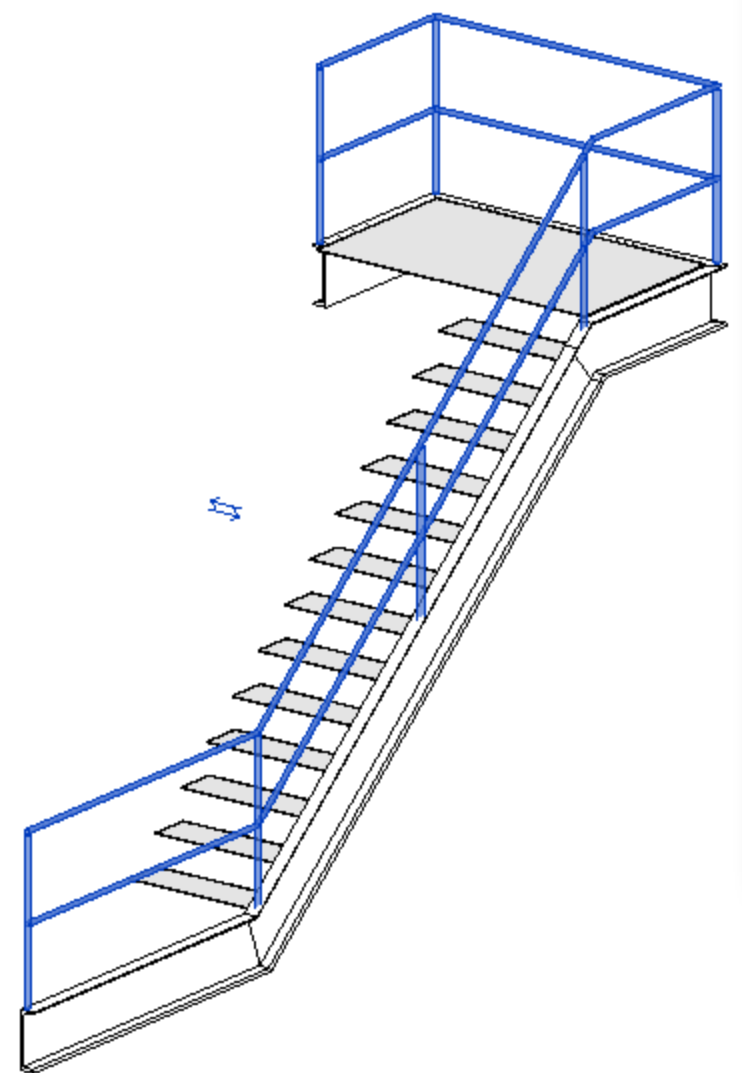

Edit Baluster Placement

Family: Railing Type: RAIL_No Stringer 5A

Main pattern

	Name	Baluster Family	Base	Base offset	Top	Top offset	Dist. from previous	Offset
1	Pattern start	N/A	N/A	N/A	N/A	N/A	N/A	N/A
2	Regular baluster	M_Baluster - Round1 : 38mm	Host	0' 0"	Rail 1	0' 0"	5' 0"	0' 0"
3	Pattern end	None	N/A	N/A	N/A	N/A	0' 0"	N/A

Break Pattern at: Each Segment End Angle: 0.00° Pattern Length: 5' 0"

Justify: Spread Pattern To Fit Excess Length Fill : None Spacing: 1' 11 159/

☐ Use Baluster Per Tread On Stairs Balusters Per Tread: 4 Baluster Family: None

Posts

	Name	Baluster Family	Base	Base offset	Top	Top offset	Space	Offset
1	Start Post	M_Baluster - Round1 : 38mm	Host	0' 0"	Rail 1	0' 0"	0' 0"	0' 0"
2	Corner Post	M_Baluster - Round1 : 38mm	Host	0' 0"	Rail 1	0' 0"	0' 0"	0' 0"
3	End Post	M_Baluster - Round1 : 38mm	Host	0' 0"	Rail 1	0' 0"	0' 0"	0' 0"

Corner Posts At: Each Segment End Angle: 0.00°

<< Preview OK Cancel Apply Help

Pipe 1XS

Search parameters

Parameter	Value	Formula	Lock
Dimensions			
Wall Design Thickness	0.166"	=	
Structural Analysis			
Section Area	0.602 in ²	=	
Perimeter		=	
Nominal Weight	2.17 lbf/ft	=	
Moment of Inertia strong axis	0.101 in ⁴	=	
Moment of Inertia weak axis	0.101 in ⁴	=	
Elastic Modulus strong axis	0.1540 in ³	=	
Elastic Modulus weak axis	0.1540 in ³	=	
Plastic Modulus strong axis	0.2210 in ³	=	
Plastic Modulus weak axis	0.2210 in ³	=	
Torsional Moment of Inertia	0.202 in ⁴	=	
Torsional Modulus	0.0000 in ³	=	
Warping Constant	0.000 in ⁶	=	
Shear Area strong axis		=	
Shear Area weak axis		=	
Principal Axes Angle		=	<input type="checkbox"/>
Structural Section Geometry			
Diameter	1.320"	=	
Wall Nominal Thickness	0.179"	=	
Centroid Horizontal	0.660"	= Diameter / 2	
Centroid Vertical	0.660"	= Diameter / 2	
Other			
d	0' 0 123/128"	= Diameter - 2 * Wall Nominal Thickness	<input checked="" type="checkbox"/>
Identity Data			

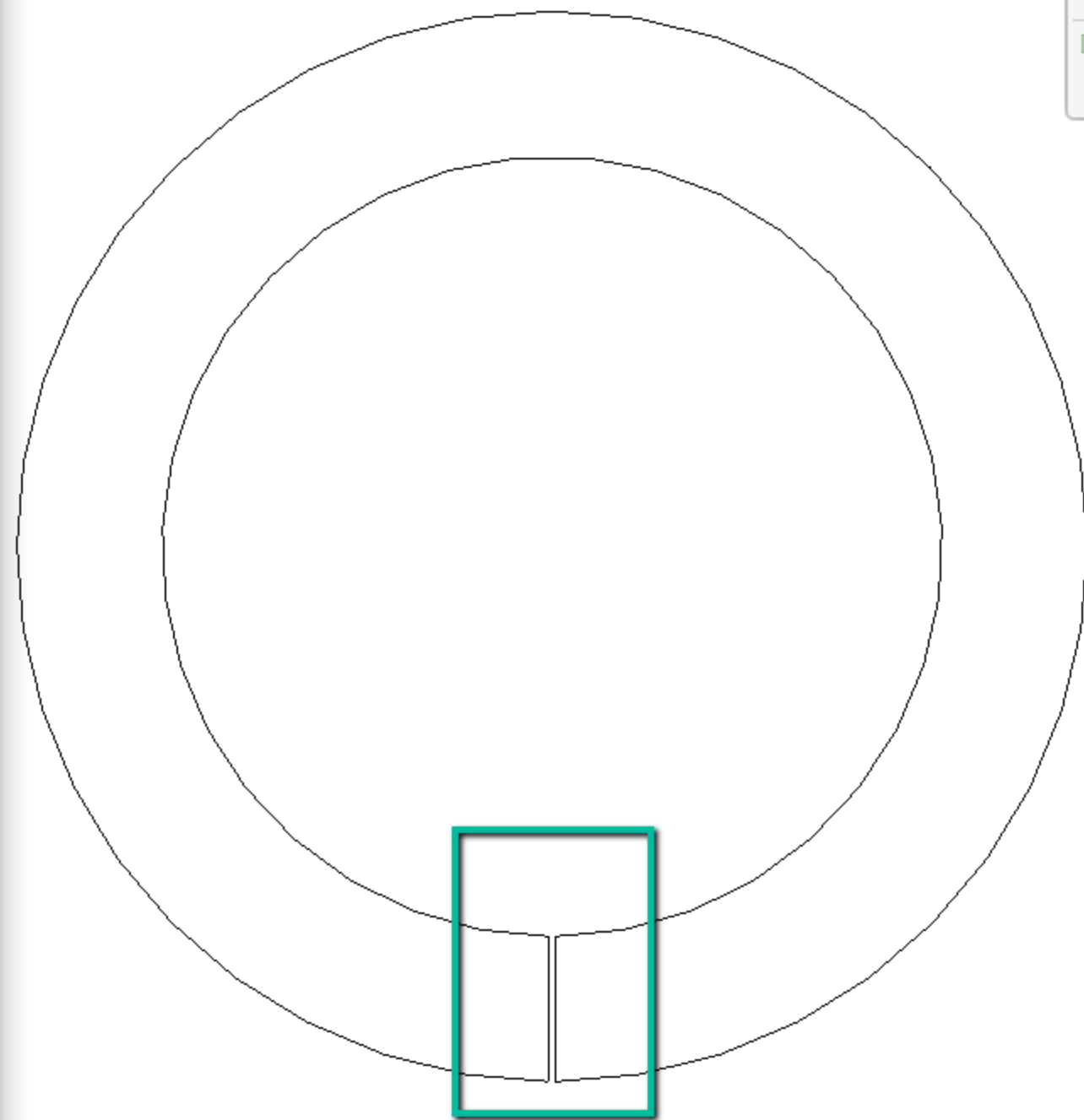

Type name: C15X50

Search parameters

Parameter	Value	Formula	Lock
Structural			
W	50.000000	=	
A	0.10	=	
Dimensions			
x	0' 0 205/256"	=	<input checked="" type="checkbox"/>
tw	0' 0 183/256"	=	<input checked="" type="checkbox"/>
tf	0' 0 83/128"	=	<input checked="" type="checkbox"/>
d	1' 3"	=	<input checked="" type="checkbox"/>
bf	0' 3 23/32"	=	<input checked="" type="checkbox"/>

Identity Data

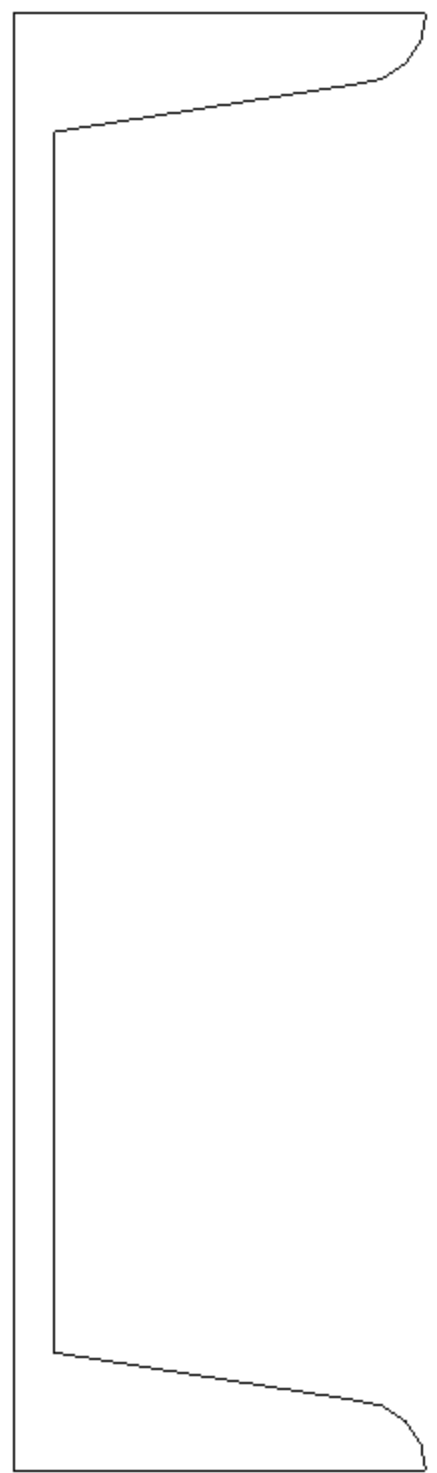

<Railing Schedule>

A	B	C	D	E	F	G	H
Type	Count	Length	AAA	BBB	CCC	DDD	EEE
RAIL_No Stringer 5A	1	11.09					
STRINGER_No Rail 5A	1	11.09					
RAIL_No Stringer 5B	1	10.97					
STRINGER_No Rail 5B	1	10.97					

Schedule Properties

Fields Filter Sorting/Grouping Formatting Appearance

Select available fields from:

Railings

Parameter Name Search:

Filter Available Fields

Available fields: 30 items

Assembly Code
Assembly Description
Assembly Name
Base Level
Base Offset
Comments
Cost
Description
EXIST PHASE
Family
Family and Type
IfcGUID
Image
ISSUE-BOX-E
Keynote
Manufacturer
Mark

Scheduled fields (in order):

Type
Count
Length
AAA
BBB
CCC
DDD
EEE

Include elements in links

Parameter Properties

Parameter Type

☐ Project parameter

(Can appear in schedules but not in tags)

☐ Shared parameter

(Can be shared by multiple projects and families, exported to ODBC, and appear in schedules and tags)

Select...

Export...

Parameter Data

Name:

AAA

☐ Type

Discipline:

Common

☒ Instance

Type of Parameter:

Area

☐ Values are aligned per group type

☒ Values can vary by group instance

Group parameter under:

Structural Analysis

Tooltip Description:

<No tooltip description. Edit this parameter to write a custom tooltip. Custom tooltips have a limit of 250 characters.>

Edit Tooltip...

☒ Add to all elements in the selected categories

Categories

Category name search:

Filter list: <multiple>

☐ Hide un-checked categories

- ☐ Mechanical Equipment
- ☐ Medical Equipment
- ☐ Model Groups
- ☐ Parking
- ☐ Parts
- ☐ Planting
- ☐ Plumbing Fixtures
- ☐ Project Information
- ☒ Railings
 - ☒ Handrails
 - ☒ Supports
 - ☒ Terminations
 - ☒ Top Rails
- ☐ Ramps
- ☐ Rebar Shape
- ☐ Roads
- ☒ Roofs
- ☐ Rooms
- ☐ RVT Links

Check All

Check None

OK

Cancel

Help

<Railing Schedule>

A	B	C	D	E	F	G	H
Type	Count	Length	AAA	BBB	CCC	DDD	EEE
RAIL_No Stringer 5A	1	11.09					
STRINGER_No Rail 5A	1	11.09					
RAIL_No Stringer 5B	1	10.97					
STRINGER_No Rail 5B	1	10.97					

Schedule Properties

Fields Filter Sorting/Grouping Formatting Appearance

Select available fields from:

Railings

Parameter Name Search:

Filter Available Fields

Available fields: 30 items

Assembly Code
Assembly Description
Assembly Name
Base Level
Base Offset
Comments
Cost
Description
EXIST PHASE
Family
Family and Type
IfcGUID
Image
ISSUE-BOX-E
Keynote
Manufacturer
Mark

Scheduled fields (in order):

Type
Count
Length
AAA
BBB
CCC
DDD
EEE



☐ Include elements in links

Parameter Properties

Parameter Type

☐ Project parameter

(Can appear in schedules but not in tags)

☐ Shared parameter

(Can be shared by multiple projects and families, exported to ODBC, and appear in schedules and tags)

Select...

Export...

Parameter Data

Name:

BBB

☐ Type

Discipline:

Common

☐ Instance

Type of Parameter:

Area

☒ Values are aligned per group type

☐ Values can vary by group instance

Group parameter under:

Structural Analysis

Tooltip Description:

<No tooltip description. Edit this parameter to write a custom tooltip. Custom tooltips have a limit of 250 characters.>

Edit Tooltip...

☒ Add to all elements in the selected categories

Categories

Category name search:

Filter list: <multiple>

☐ Hide un-checked categories

- ☐ Parking
- ☐ Planting
- ☐ Plumbing Fixtures
- ☒ Railings
 - ☒ Handrails
 - ☒ Supports
 - ☒ Terminations
 - ☒ Top Rails
- ☐ Ramps
- ☐ Rebar Shape
- ☐ Roads
- ☒ Roofs
- ☐ RVT Links
- ☐ Signage
- ☒ Site
- ☐ Specialty Equipment
- ☒ Stairs
- ☐ Structural Area Reinforcement
- ☐ Structural Beam Systems

Check All

Check None

OK

Cancel

Help

<Railing Schedule>

A	B	C	D	E	F	G	H
Type	Count	Length	AAA	BBB	CCC	DDD	EEE
RAIL_No Stringer 5A	1	11.09					
STRINGER_No Rail 5A	1	11.09					
RAIL_No Stringer 5B	1	10.97					
STRINGER_No Rail 5B	1	10.97					

Schedule Properties

Fields Filter Sorting/Grouping Formatting Appearance

Select available fields from:

Railings

Parameter Name Search:

Filter Available Fields

Available fields: 30 items

Assembly Code
Assembly Description
Assembly Name
Base Level
Base Offset
Comments
Cost
Description
EXIST PHASE
Family
Family and Type
IfcGUID
Image
ISSUE-BOX-E
Keynote
Manufacturer
Mark

Scheduled fields (in order):

Type
Count
Length
AAA
BBB
CCC
DDD
EEE

Parameter Properties

Parameter Type

☒ Project parameter

(Can appear in schedules but not in tags)

☐ Shared parameter

(Can be shared by multiple projects and families, exported to ODBC, and appear in schedules and tags)

Select...

Export...

Parameter Data

Name:

CCC

☐ Type

Discipline:

Structural

☒ Instance

Type of Parameter:

Section Area

☒ Values are aligned per group type

☐ Values can vary by group instance

Group parameter under:

Structural

Tooltip Description:

<No tooltip description. Edit this parameter to write a custom tooltip. Custom tooltips have a limit of 250 characters.>

Edit Tooltip...

☒ Add to all elements in the selected categories

Categories

Category name search:

Filter list: <multiple>

☐ Hide un-checked categories

☐ Model Groups
☐ Parking
☐ Parts
☐ Planting
☐ Plumbing Fixtures
☐ Project Information
☒ Railings
 ☒ Handrails
 ☒ Supports
 ☒ Terminations
 ☒ Top Rails
☐ Ramps
☐ Rebar Shape
☐ Roads
☒ Roofs
☐ Rooms
☐ RVT Links
☐ Schedules
☐ Shaft Openings

Check All

Check None

OK

Cancel

Help

<Railing Schedule>

A	B	C	D	E	F	G	H
Type	Count	Length	AAA	BBB	CCC	DDD	EEE
RAIL_No Stringer 5A	1	11.09					
STRINGER_No Rail 5A	1	11.09					
RAIL_No Stringer 5B	1	10.97					
STRINGER_No Rail 5B	1	10.97					

Schedule Properties

Fields Filter Sorting/Grouping Formatting Appearance

Select available fields from:

Railings

Parameter Name Search:

Filter Available Fields

Available fields: 30 items

Assembly Code
Assembly Description
Assembly Name
Base Level
Base Offset
Comments
Cost
Description
EXIST PHASE
Family
Family and Type
IfcGUID
Image
ISSUE-BOX-E
Keynote
Manufacturer
Mark

Scheduled fields (in order):

Type
Count
Length
AAA
BBB
CCC
DDD
EEE



Include elements in links

Parameter Properties

Parameter Type

☒ Project parameter

(Can appear in schedules but not in tags)

☐ Shared parameter

(Can be shared by multiple projects and families, exported to ODBC, and appear in schedules and tags)

Select...

Export...

Parameter Data

Name:

DDD

☒ Type

Discipline:

Common

☐ Instance

Type of Parameter:

Area

☒ Values are aligned per group type

☐ Values can vary by group instance

Group parameter under:

Structural Analysis

Tooltip Description:

<No tooltip description. Edit this parameter to write a custom tooltip. Custom tooltips have a limit of 250 characters.>

Edit Tooltip...

☒ Add to all elements in the selected categories

Categories

Category name search:

Filter list: <multiple>

☐ Hide un-checked categories

- ☐ Levels
- ☐ Lighting Fixtures
- ☐ Mass
- ☐ Mechanical Equipment
- ☐ Medical Equipment
- ☐ Model Groups
- ☐ Parking
- ☐ Planting
- ☐ Plumbing Fixtures
- ☒ Railings
 - ☒ Handrails
 - ☒ Supports
 - ☒ Terminations
 - ☒ Top Rails
- ☐ Ramps
- ☐ Rebar Shape
- ☐ Roads
- ☐ Roofs
- ☐ RVT Links

Check All

Check None

OK

Cancel

Help

<Railing Schedule>

A	B	C	D	E	F	G	H
Type	Count	Length	AAA	BBB	CCC	DDD	EEE
RAIL_No Stringer 5A	1	11.09					
STRINGER_No Rail 5A	1	11.09					
RAIL_No Stringer 5B	1	10.97					
STRINGER_No Rail 5B	1	10.97					

Schedule Properties

Fields Filter Sorting/Grouping Formatting Appearance

Select available fields from:

Railings

Parameter Name Search:

Filter Available Fields

Available fields: 30 items

Assembly Code
Assembly Description
Assembly Name
Base Level
Base Offset
Comments
Cost
Description
EXIST PHASE
Family
Family and Type
IfcGUID
Image
ISSUE-BOX-E
Keynote
Manufacturer
Mark

Scheduled fields (in order):

Type
Count
Length
AAA
BBB
CCC
DDD
EEE

Parameter Properties

Parameter Type

☒ Project parameter

(Can appear in schedules but not in tags)

☐ Shared parameter

(Can be shared by multiple projects and families, exported to ODBC, and appear in schedules and tags)

Select...

Export...

Parameter Data

Name:

EEE

☐ Type

Discipline:

Structural

☒ Instance

Type of Parameter:

Section Area

☒ Values are aligned per group type

☐ Values can vary by group instance

Group parameter under:

Structural Analysis

Tooltip Description:

<No tooltip description. Edit this parameter to write a custom tooltip. Custom tooltips have a limit of 250 characters.>

Edit Tooltip...

Categories

Category name search:

Filter list: <multiple>

☐ Hide un-checked categories

- ☐ Lighting Fixtures
- ☒ Lines
 - ☐ Mass
 - ☐ Materials
 - ☐ Mechanical Equipment
 - ☐ Medical Equipment
 - ☐ Model Groups
 - ☐ Parking
 - ☐ Parts
 - ☐ Planting
 - ☐ Plumbing Fixtures
 - ☐ Project Information
- ☒ Railings
 - ☒ Handrails
 - ☒ Supports
 - ☒ Terminations
 - ☒ Top Rails
- ☐ Ramps
- ☐ Rebar Shape

Check All

Check None

☒ Add to all elements in the selected categories

OK

Cancel

Help

☐ Include elements in links