

NOTLAR / Notes ;

- Birim / Units :** Milimetre/milimeter (mm) ve derece/degree (°), kilogram/kilogram (kg)'dir.
- Genel tolerans / General Tolerances :** Aksi belirtilmedikçe/ unless indicated otherwise doğrusal değerler için/for linear values ± 0.5 mm, açılal değerler için/ for angular values $\pm 1^\circ$.
- Malzeme / Material :** (40.SHRP1.04), Sac Levha, Çelik, HRP, 4 mm.
- Kaplama / Plating :** Galvaniz
- Boyama / Painting :** YOK
- Operasyonlar / Processes :** Lazer
- Özel İşlem / Special Description :** Yok

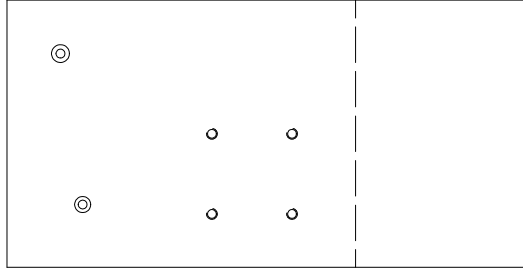

Ø5 THRU
Ø9

M6x1 - 6H

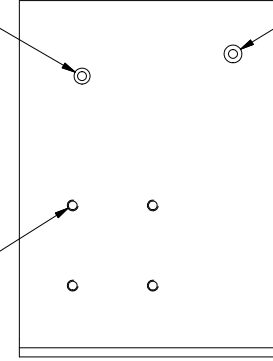

Ø5 THRU
Ø10 X 90°

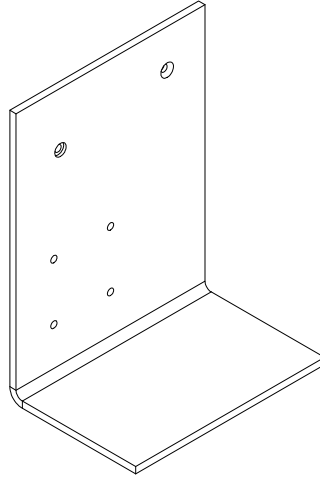
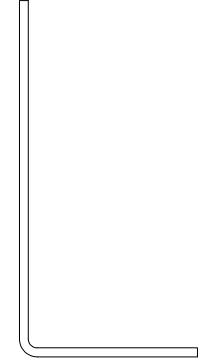

REV./ Rev.	AÇIKLAMA / Description	TARİH/ Date	ONAY/ Approved
00	Resim 00 revizyonu ile oluşturuldu. /Drawing created with revision 00./...../.....	Ahmet ŞEVİK

POZ./ AD./ Item Qty.	PARÇA NO/ Part No	PARÇA ADI/ Part Name	HAMMADDE NO/ Raw Material No	KG./ REV/ Weight Rev.
ÇİZİM/ Designer	Ahmet SEVİK	23.03.2017		
TASARIM/ Engineer	Ahmet ŞEVİK	23.03.2017		
KONTROL/ Checked	Enis TAŞKIN/...../.....		
ONAY/ Approved	Yusuf CULHALIK/...../.....		
GÖKSU KAPI MEKATRONİK YAPI TEKNOLOJİLERİ SAN. VE TİC. A.Ş. www.goksu.com.tr Dudullu O.S.B., 3. Cadde, No:14, 34775 Ümraniye / İSTANBUL Tel:(+90 216) 466 89 89 Fax:(+90 216) 466 89 80			PARÇA NO: / Part Number Part1	
GÖKSU			PARÇA ADI: / Part Name VİRA VAGON	
GÖKSU			AĞIRLIK: / Weight N/A	
GÖKSU			ÖLÇEK: / Scale X:X	
GÖKSU			SAYFA: / Page Nr. 1 / 1	