

File Edit View Geometry Loads Analysis Results Design Tools Add-Ins Window Help

Slab - required reinforcement

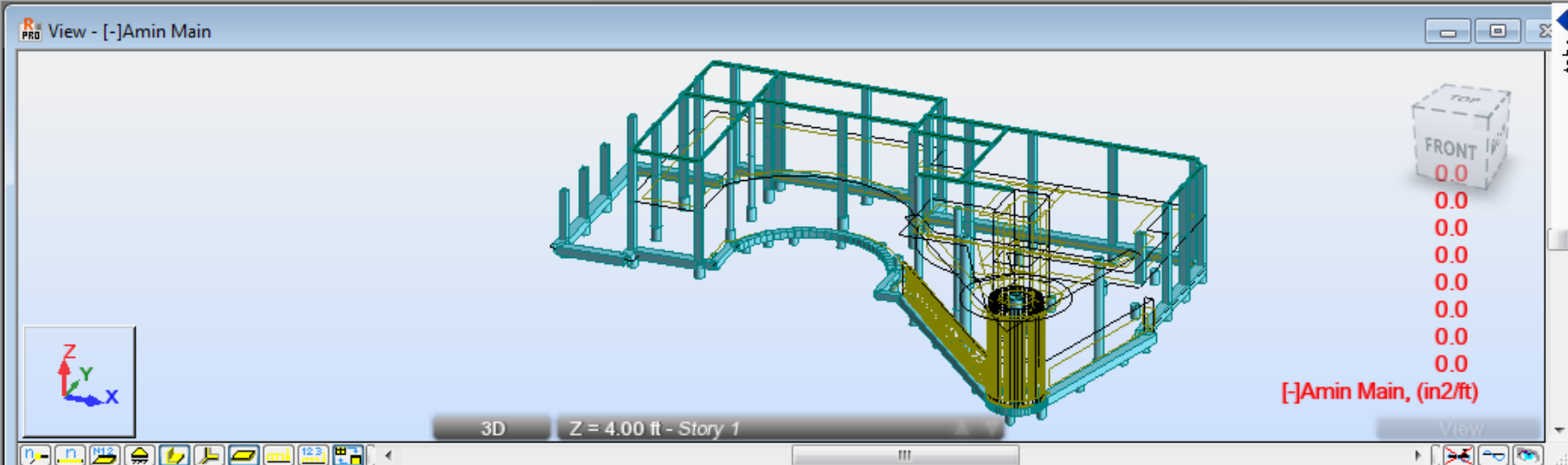

Reinforcements

Reinforcement SLS Scale

	X[-]	Y[-]	X[+]	Y[+]
Required reinforcement:				
Area A	<input type="checkbox"/>	<input type="checkbox"/>	<input type="checkbox"/>	<input type="checkbox"/>
Spacing e	<input type="checkbox"/>	<input type="checkbox"/>	<input type="checkbox"/>	<input type="checkbox"/>
Number of bars n	<input type="checkbox"/>	<input type="checkbox"/>	<input type="checkbox"/>	<input type="checkbox"/>
Minimum reinforcement:				
Area A	<input checked="" type="checkbox"/>	<input type="checkbox"/>	<input type="checkbox"/>	<input type="checkbox"/>
Spacing e	<input type="checkbox"/>	<input type="checkbox"/>	<input type="checkbox"/>	<input type="checkbox"/>
Number of bars n	<input type="checkbox"/>	<input type="checkbox"/>	<input type="checkbox"/>	<input type="checkbox"/>

Cross presentation:
 (+) top (-) bottom description starts with:
 reinforcement areas in2
 reinforcement spacing in

smoothing within a panel
 Isolines With normalization
 Maps With FE mesh
 Values With description
 Open new window with scale displayed

Apply Close Help

Plate and Shell Reinforcement

List of panels: 1 5 7 41to44 137to141 153t ... << Calculations Verification

Calculations for panel no.: Calculate

Calculated panels: Close

Limit states
 ULS 19 ...
 SLS ...
 ACC ...

Method: equivalent mom. (Wood&Armer) ...

Globally averaged design forces
 Reduction of forces (at supports or above columns and walls)

Deflection verification
 Method:
 Equivalent stiffness (Elastic)
 With stiffness update (FEM)

Displacement (+) Auto
 Displacement (-) Auto

Help