

## DRAWING EDITING – USING THE EDITION LAYOUT TAB

### REVIEW

In this section we will look at the commands and processes users have to use to successfully edit your drawings.

For this example we will look at a simple part drawing of a beam.

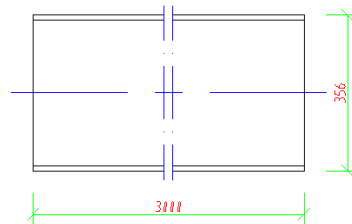

*p 1 UB 360x50.7 1 pcs  
scale 1:10*

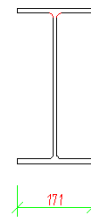

*p 1 UB 360x50.7 Side  
scale 1:10*

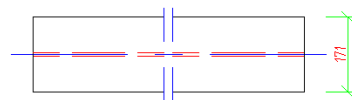

*p 1 UB 360x50.7 Top  
scale 1:10*

To perform any editing on a drawing this must be done on the Edition tab. What appears in the Edition tab for editing depends on what is selected under the Positions tab on the Object Inspector.

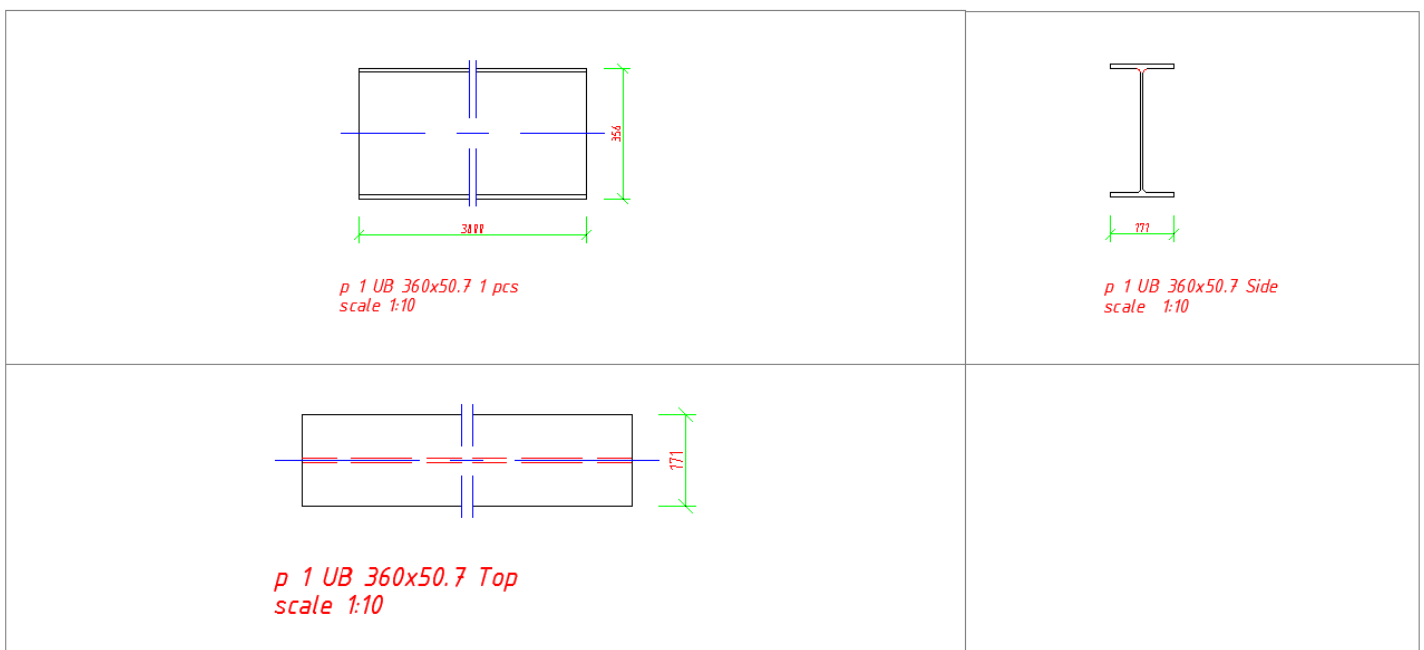

The Edition tab is a typical AutoCAD Model Space / Paper Space environment. If the user double clicks in any rectangle (viewport) surrounding a view they are in Model Space and can edit the view.

However, if we double click in the top left rectangle (activate the viewport) and ERASE the dimensions from the view....we have not edited this view properly.

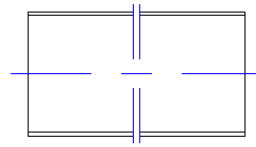

*p 1 UB 360x50.7 1 pcs  
scale 1:10*

If we return to the actual drawing tab, the dimensions do appear to have been deleted:

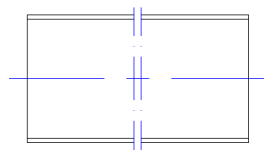

*p 1 UB 360x50.7 1 pcs  
scale 1:10*



*p 1 UB 360x50.7 Side  
scale 1:10*

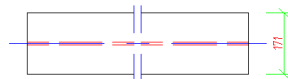

*p 1 UB 360x50.7 Top  
scale 1:10*

However, if the drawing is UPDATED for any reason the dimensions reappear:

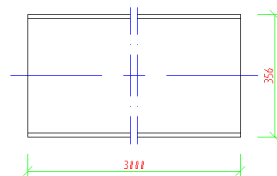

*p 1 UB 360x50.7 1 pcs  
scale 1:10*



*p 1 UB 360x50.7 Side  
scale 1:10*

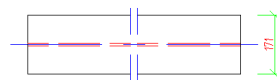

*p 1 UB 360x50.7 Top  
scale 1:10*

To edit the dimensions correctly, return to the Edition Layout tab. Ensure the viewport you wish to edit is activated (double click in it) if it is not already.



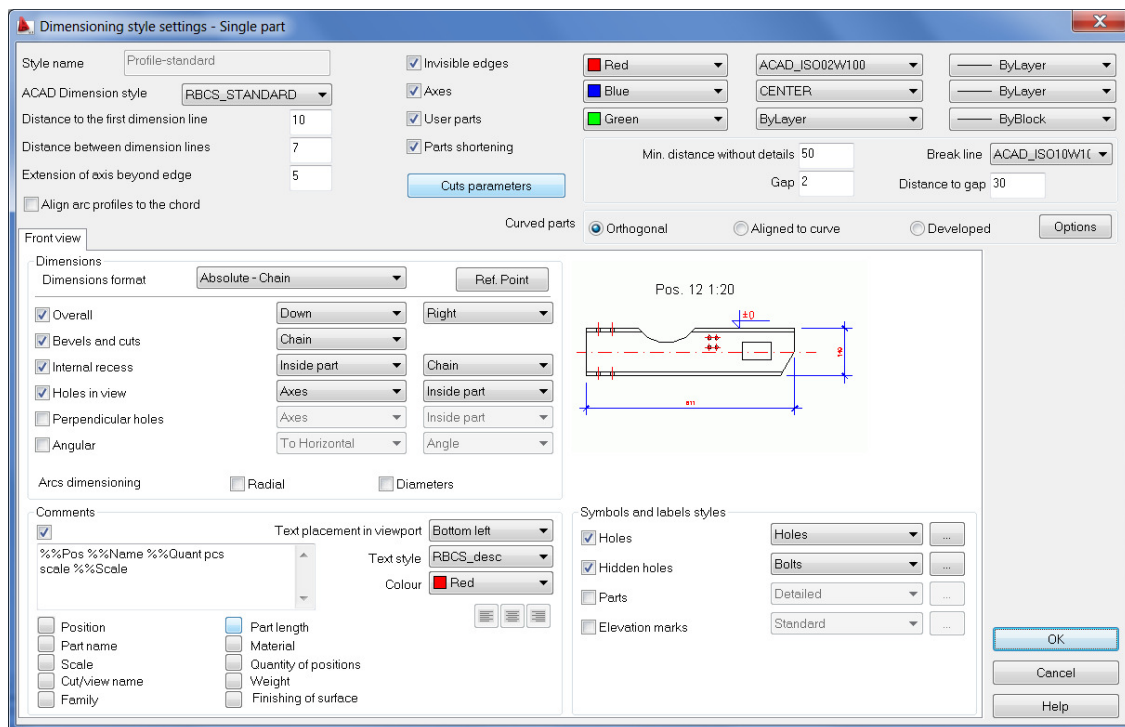

Adjust style

On the Ribbon, select ASD-Drawings > Drawings Edition > , this will bring up the Dimension Style Setting dialog box.

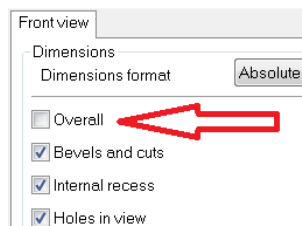

Have a look at the Front View tab area under dimensions, switch OFF Overall dimensions.



Select the  button and return to the actual drawing tab, even if updated the dimension stays erased.

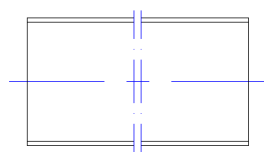

p 1 UB 360x50.7 1 pcs  
scale 1:10



p 1 UB 360x50.7 Side  
scale 1:10



p 1 UB 360x50.7 Top  
scale 1:10

So you must use the command to manage how your drawings appear.

It should be noted that users can add dimensions of their own in the active viewport under the Editions Layout tab, and the dimensions remain there through Updates etc.