

Original group 1.
Walls are set to floor
to floor.

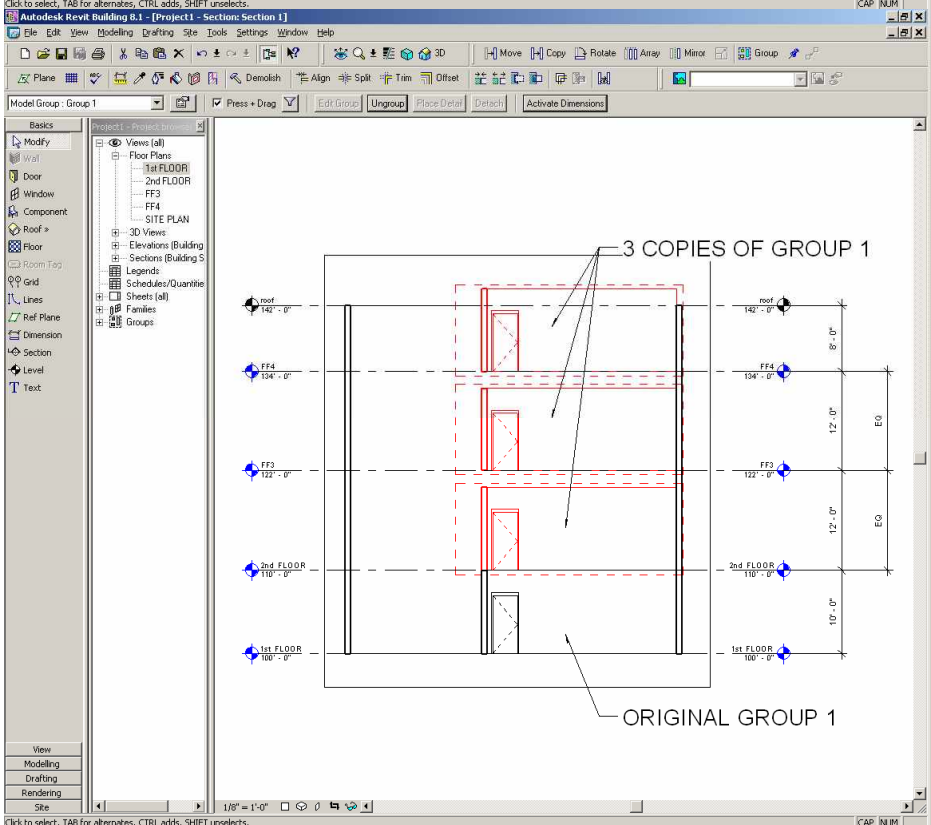

Original group 1
was copied to 2nd,
3rd, and 4th floors.

Notice the heights of
the walls do not
change.

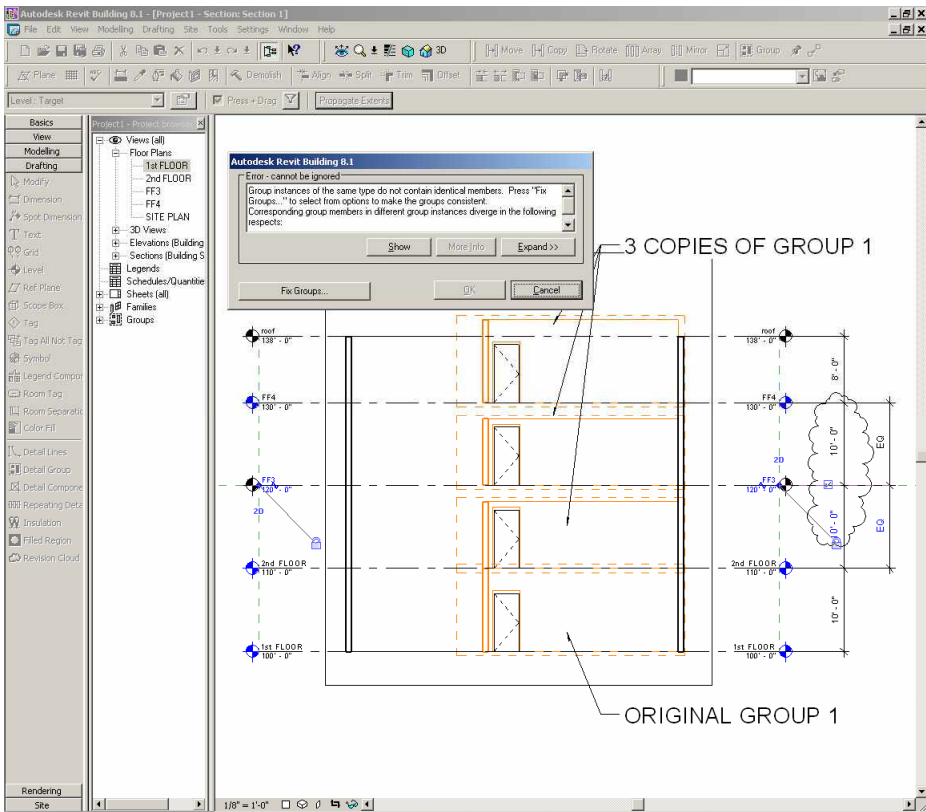

Sure "Fix Group" what could it possibly do.

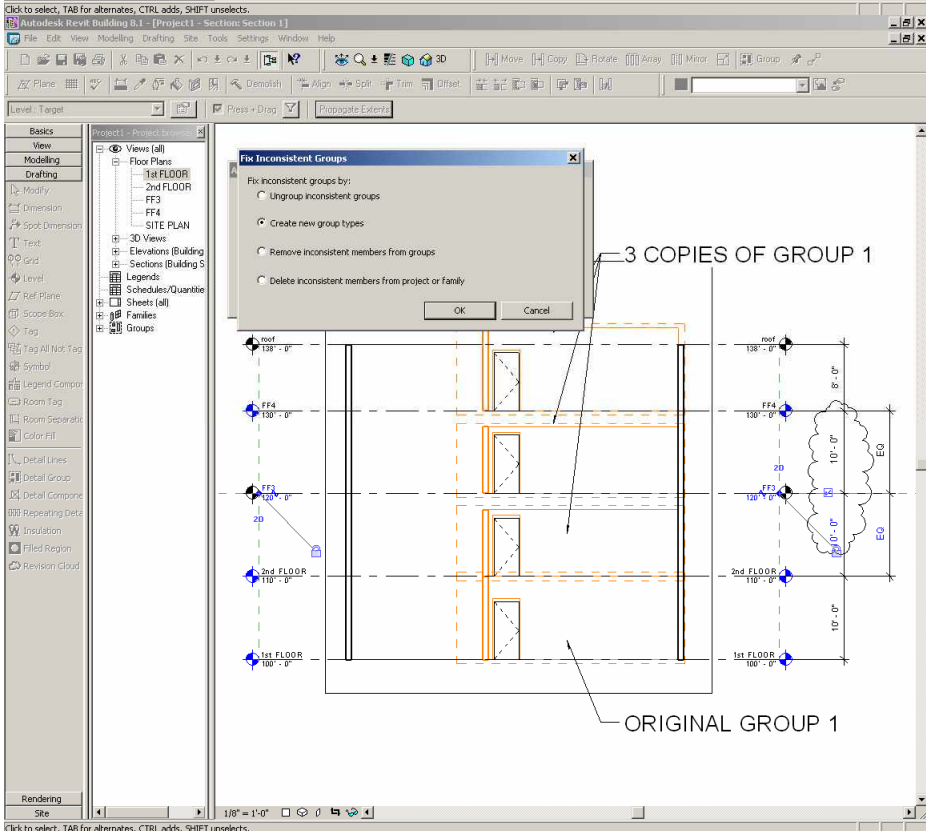

Create new group types.

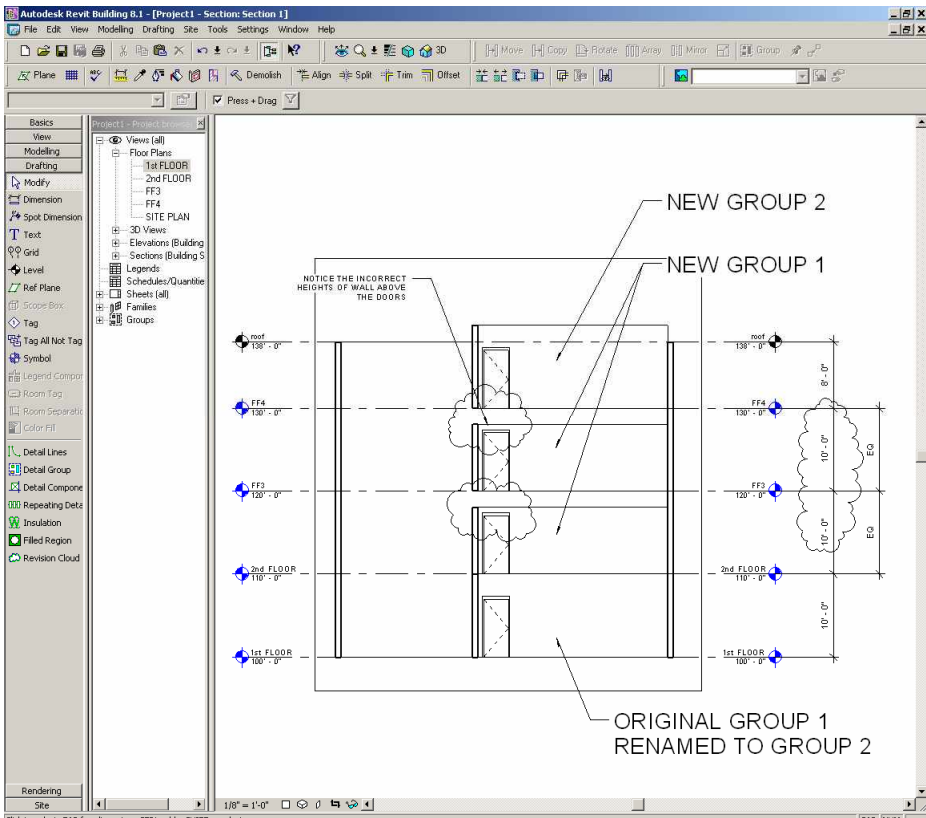

The original group 1 was renamed to group 2. Why can't it leave my group 1 alone???

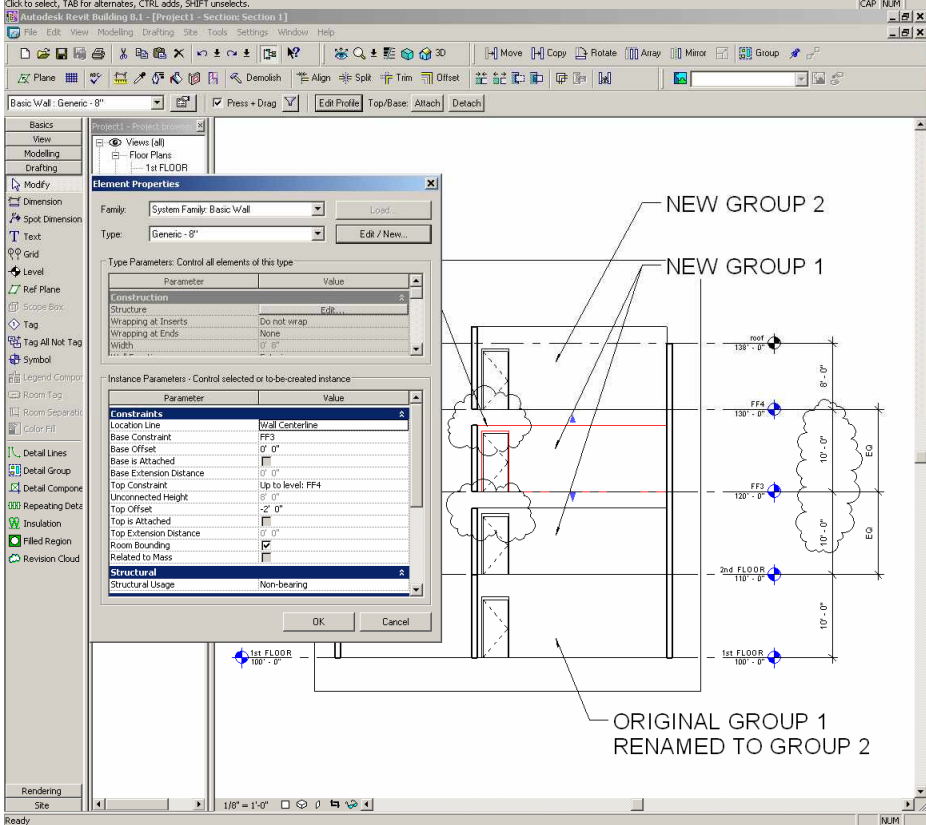

Note the walls are set to floor to floor but there is a -2'-0" on the top offset.

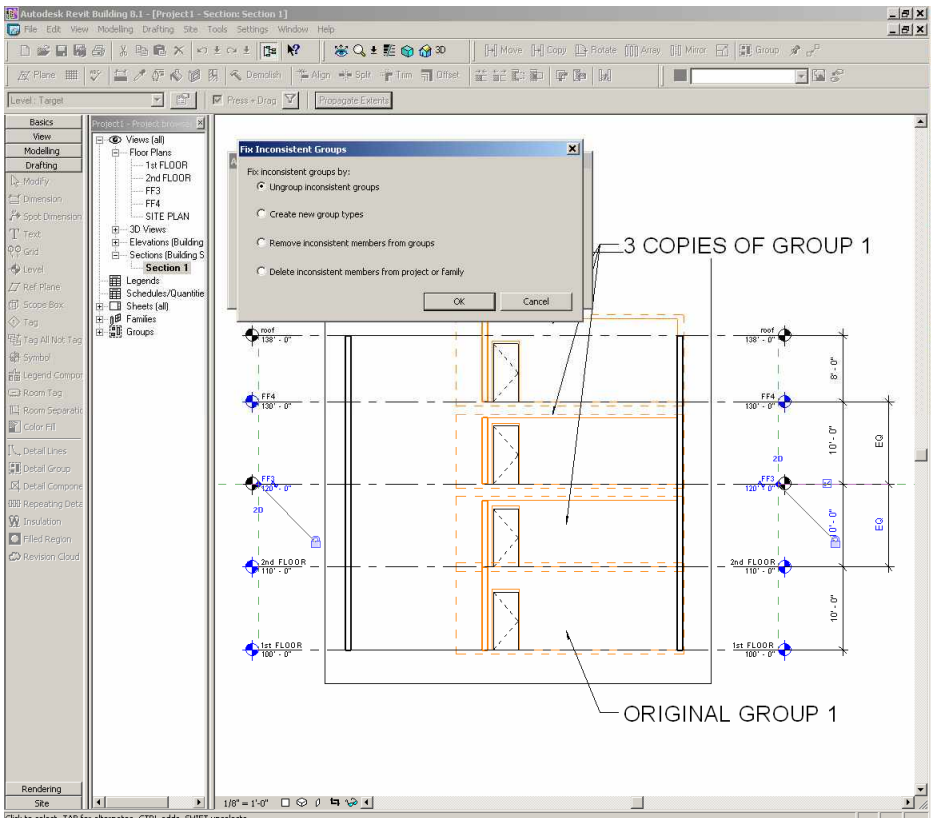

Ungroup inconsistent groups.

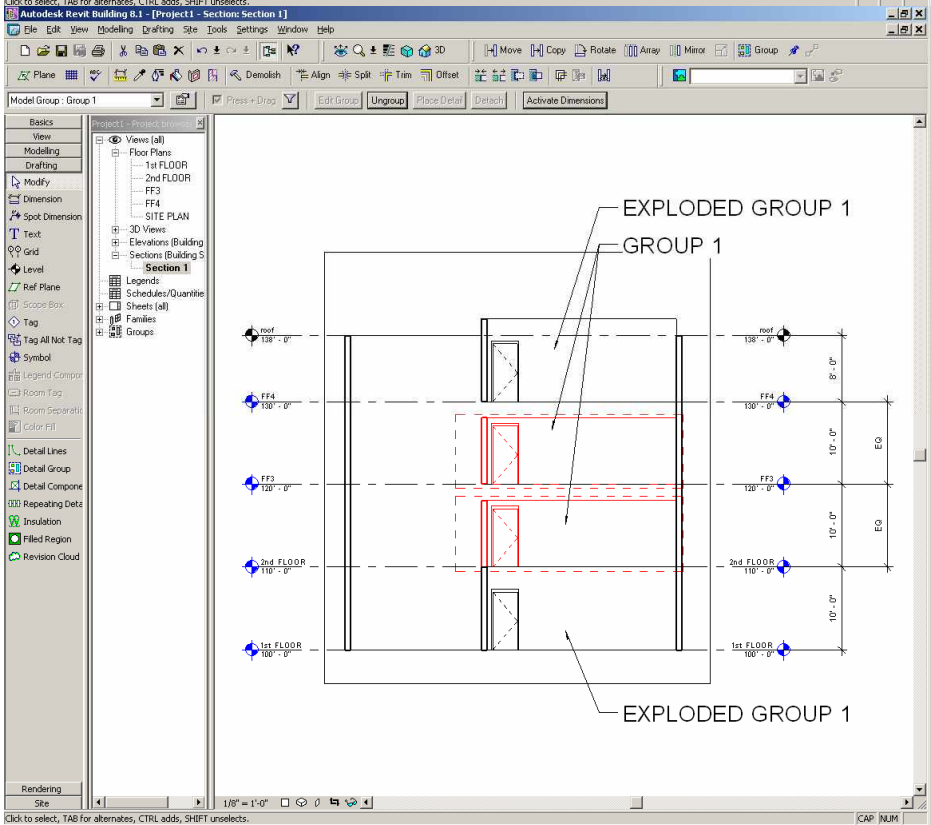

Just left the group 1 objects. But it is not the original group 1!!! If you investigate the remaining group 1 walls you will see that they are still set floor to floor but have a -2'-0" top offset. This is frustrating!!!

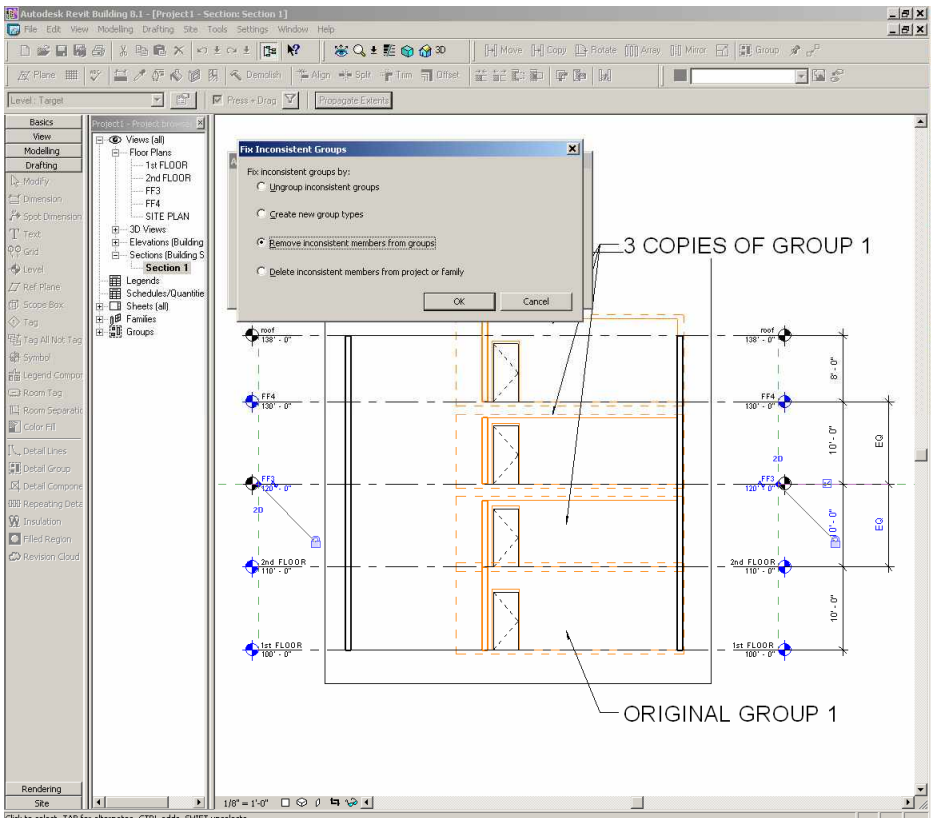

Remove inconsistent members from groups.

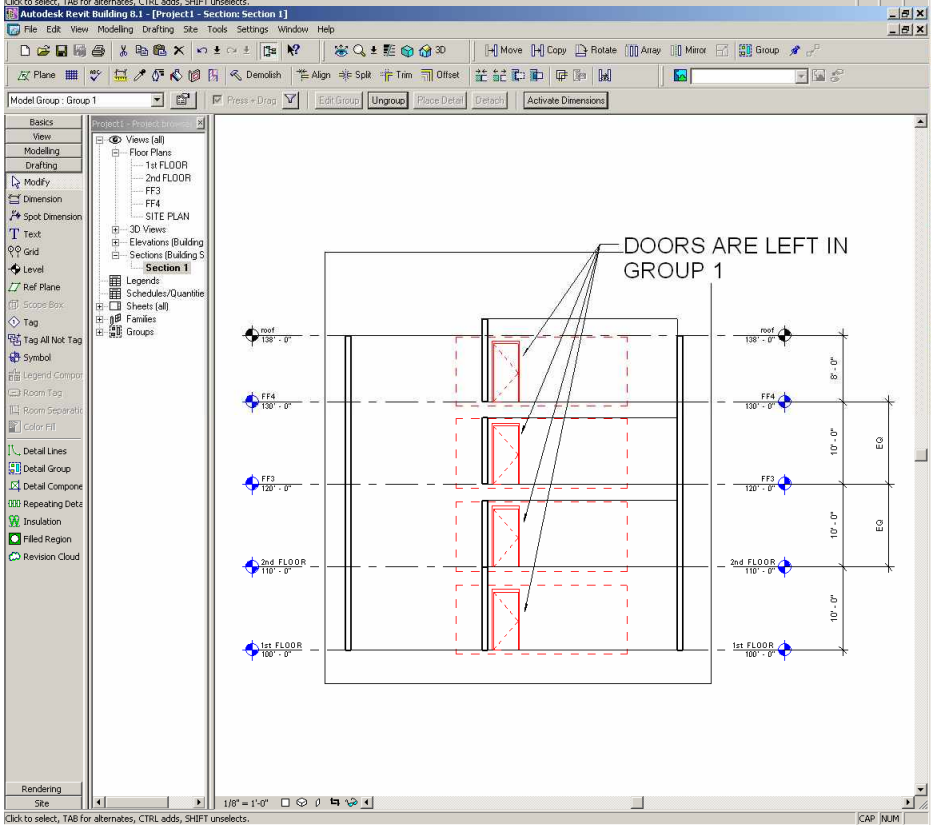

Just the doors were left in the groups. Not very helpful.

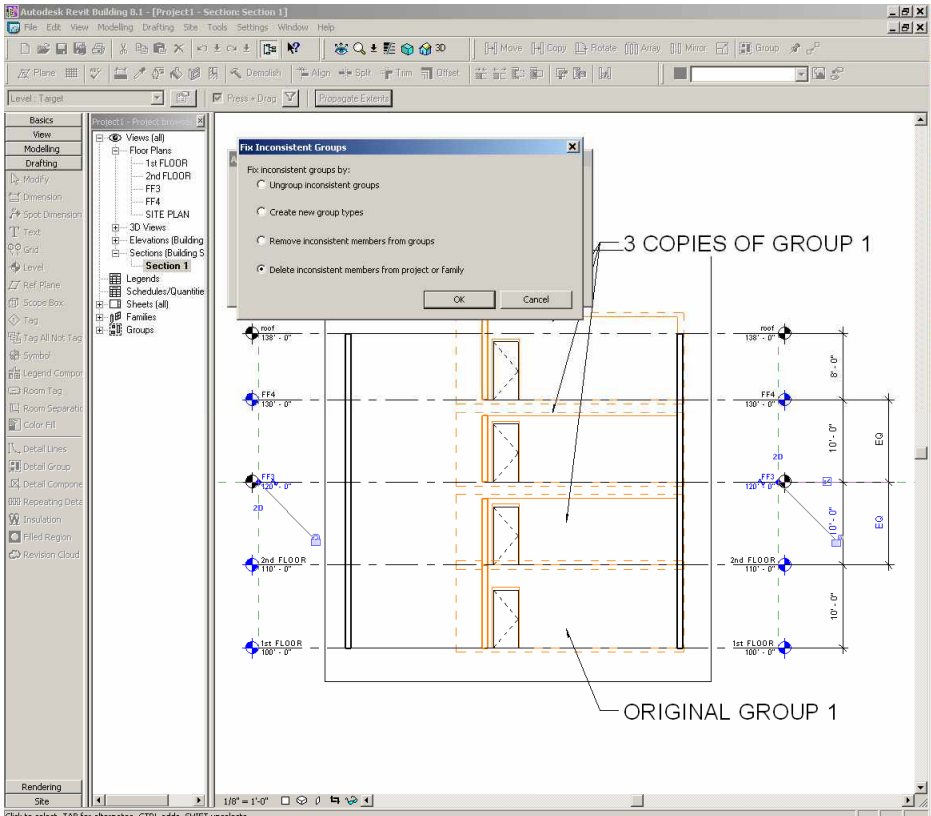

Delete inconsistent members from project or family

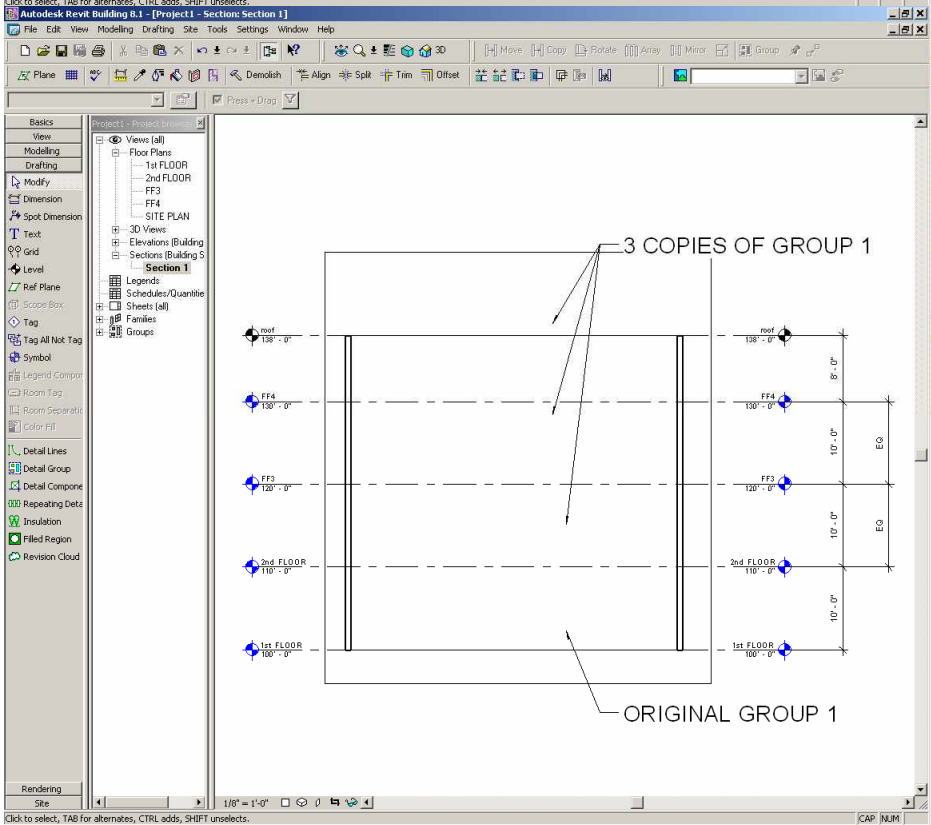

Everything was ERASED